





Similar Image

Duo 3 M DC, 24 V DC

- Dual-stage, high-performance rotary vane pump with a pumping speed of 2.7 m³/h
- With magnetic coupling
- With 24 V DC-drive
- Integrated gas ballast and safety valve
- Oil return device is included with the pump
- Suitable for operation with the wide range of temperature from -20 to +60 °C
- Very low noise level < 50 dB (A) allows installation close to a work space
- Low cost of ownership due to power consumption < 100 W
- Low maintenance due to brushless drive and optimal magnetic coupling
- Easy installation an small footprint

M = Magnetically coupled

Dimensions

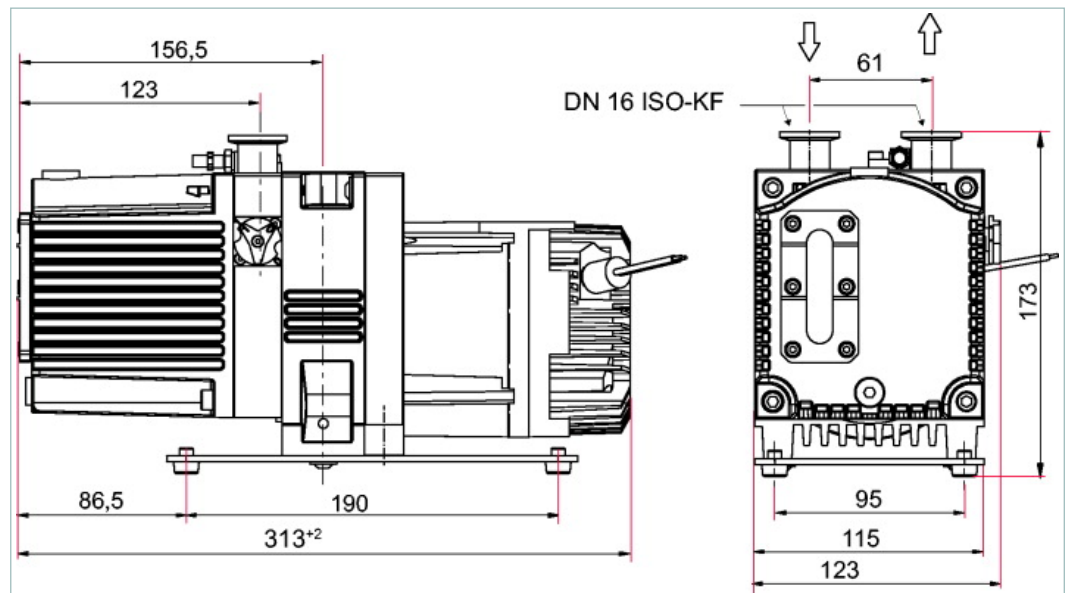

Technical Data	Duo 3 M DC, 24 V DC
Ambient temperature	-20 °C -68 °F -293 K
Cooling method, standard	Air
Exhaust pressure, max.	1,500 hPa 1,125 Torr 1,500 mbar
Exhaust pressure, min.	250 hPa 187.5 Torr 250 mbar
Flange (in)	DN 16 ISO-KF
Flange (out)	DN 16 ISO-KF
Leak rate safety valve	$\leq 1 \cdot 10^{-5}$ Pa m ³ /s $\leq 7.5 \cdot 10^{-5}$ Torr l/s $\leq 1 \cdot 10^{-4}$ mbar l/s
Motor version	DC Motor
Operating fluid	Inland 45
Operating fluid filling	0.4 l
Power consumption	210 W
Protection category	IP20
Pumping speed	2.5 m ³ /h
Rated current absorption	16 A
Rotation speed max.	3000 min ⁻¹
Supply: Voltage	24 V DC
Temperature: Storage	-25-60 °C -13-140 °F 248-333 K

Technical Data	Duo 3 M DC, 24 V DC
Temperature: Transport	-25-60 °C -13-140 °F 248-333 K
Ultimate pressure with gas ballast	$3 \cdot 10^{-3}$ hPa $2.25 \cdot 10^{-3}$ Torr $3 \cdot 10^{-3}$ mbar
Ultimate pressure without gas ballast	$3 \cdot 10^{-3}$ hPa $2.25 \cdot 10^{-3}$ Torr $3 \cdot 10^{-3}$ mbar
Weight	85 kg 187.39 lb

Typical ultimate pressure according to PNEUROP

Order number	
Duo 3/M/DC	PK D57 563