



Duo 5 M

Dual-stage, rotary vane pumps with a pumping speed of up to 6 m³/h:





Similar Image

Duo 5 M, 1-phase motor, 95-120 V, 50 Hz; 105-120 V, 60 Hz

- Dual-stage, high-performance rotary vane pump with a pumping speed of up to 6 m³/h
- With Single-phase motor
- Integrated gas ballast and HV safety valve
- For all low and medium vacuum applications
- Magnetically coupled
- Special feature: Various motor voltages for worldwide employment

M = Magnetically coupled

MC = Corrosive gas version, magnetically coupled

TF = Temperature sensor

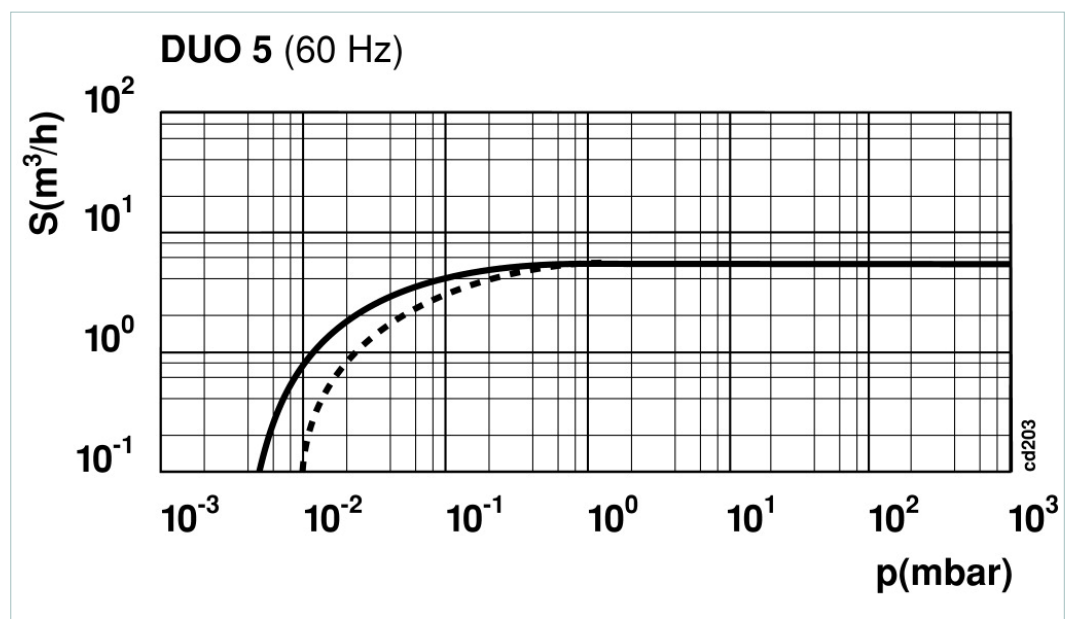

Dimensions

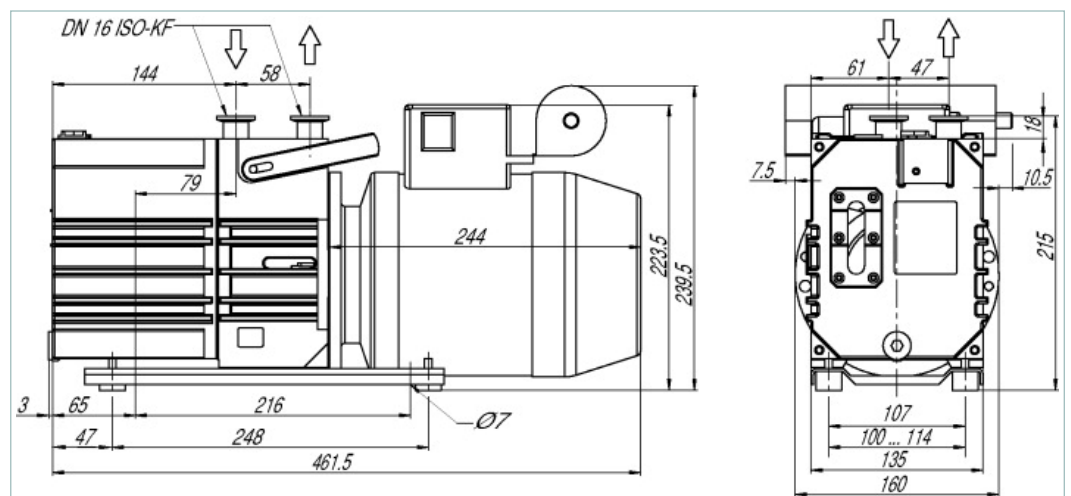

Technical Data

Duo 5 M, 1-phase motor, 95-120 V, 50 Hz;
105-120 V, 60 Hz

Ambient temperature

12-40 °C | 53.6-104 °F | 285-313 K

Cooling method, standard

Air

| Technical Data | Duo 5 M, 1-phase motor, 95-120 V, 50 Hz; 105-120 V, 60 Hz |
|--|--|
| Emission sound pressure level without gas ballast at 50 Hz | ≤ 57 dB (A) |
| Exhaust pressure, max. | 1,500 hPa 1,125 Torr 1,500 mbar |
| Exhaust pressure, min. | 250 hPa 187.5 Torr 250 mbar |
| Flange (in) | DN 16 ISO-KF |
| Flange (out) | DN 16 ISO-KF |
| Leak rate safety valve | ≤ 1 · 10 ⁻⁵ Pa m ³ /s ≤ 7.5 · 10 ⁻⁵ Torr l/s ≤ 1 · 10 ⁻⁴ mbar l/s |
| Magnetic coupling | yes |
| Mains cable | yes |
| Mains requirement: voltage 50 Hz | 95-120 (± 5 %) V |
| Mains requirement: voltage 60 Hz | 105-120 (± 5 %) V |
| Motor version | 1-phase Motor |
| Operating fluid | P3 |
| Operating fluid filling | 0.75 l |
| Protection category | IP 55 |
| Pumping speed at 50 Hz | 5 m ³ /h |
| Pumping speed at 60 Hz | 6 m ³ /h |
| Rated power 50 Hz | 0.37 kW |
| Rated power 60 Hz | 0.37 kW |
| Rotation speed at 50 Hz | 1500 min ⁻¹ |
| Rotation speed at 60 Hz | 1800 min ⁻¹ |
| Switch | yes |
| Ultimate pressure with gas ballast | 7 · 10 ⁻³ hPa 5.25 · 10 ⁻³ Torr 7 · 10 ⁻³ mbar |
| Ultimate pressure without gas ballast | 4 · 10 ⁻³ hPa 3 · 10 ⁻³ Torr 4 · 10 ⁻³ mbar |
| Weight | 25 kg 55.12 lb |

Typical ultimate pressure according to PNEUROP

| Order number |
|--------------|
| Duo 5 M |
| PK D61 707 |

| Accessories |
|--|
| Accessories UnoLine |
| KAS 16, condensate separator for pumping speeds from 1.6 to 12 m ³ /h |
| Oil pressure switch for Duo 5/10/20 M and Penta 20/35 |
| ONF 16 M, oil mist filter for pumping speeds of up to 12 m ³ /h |
| ONF 16 S, oil mist filter for pumping speeds up to 12 m ³ /h |
| Operations monitoring unit 1 for Duo 1.6/3/6/11 and Duo 5/10/20 M |
| Operations monitoring unit 2 for Duo 1.6/3/6/11 and Duo 5/10/20 M |
| Operations monitoring unit 3 for Duo 1.6/3/6/11 and Duo 5/10/20 M |
| SAS 16, DN 16 ISO-KF, polyester filter |
| ZFO 16, zeolite trap |
| Accessories UnoLine Plus |
| PTC-resistor tripping device |
| Consumables |
| P3, mineral oil, 1 l |
| P3, mineral oil, 5 l |
| P3, mineral oil, 20 l |