



# Duo 5 M

Dual-stage, rotary vane pumps with a pumping speed of up to 6 m<sup>3</sup>/h:





Similar Image

## Duo 5 MC, 1-phase motor, 200-240 V, 50 Hz; 208-240 V, 60 Hz

- Dual-stage, high-performance rotary vane pump with a pumping speed of up to 6 m<sup>3</sup>/h
- With Single-phase motor
- Integrated gas ballast and HV safety valve
- For all low and medium vacuum applications
- Corrosive gas version, magnetically coupled
- Special feature: Various motor voltages for worldwide employment

M = Magnetically coupled

MC = Corrosive gas version, magnetically coupled

TF = Temperature sensor

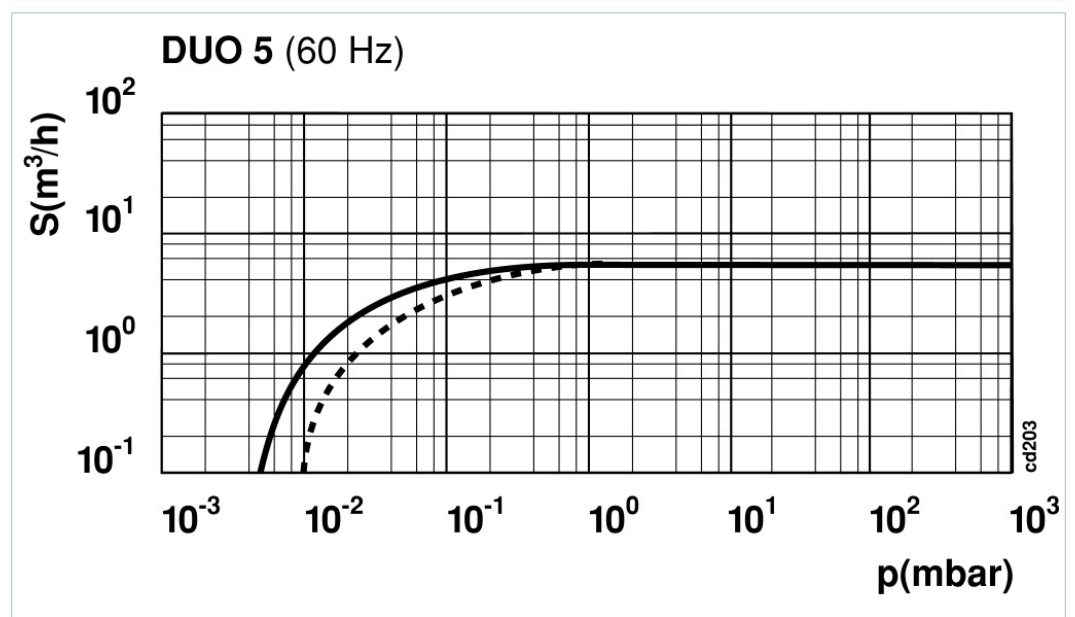
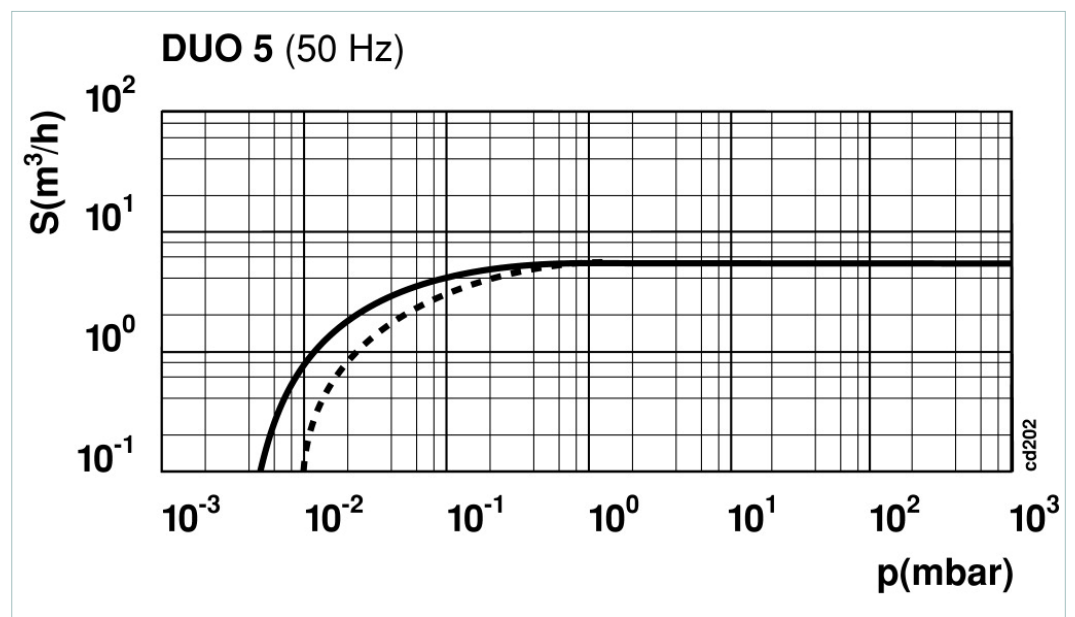

## Dimensions

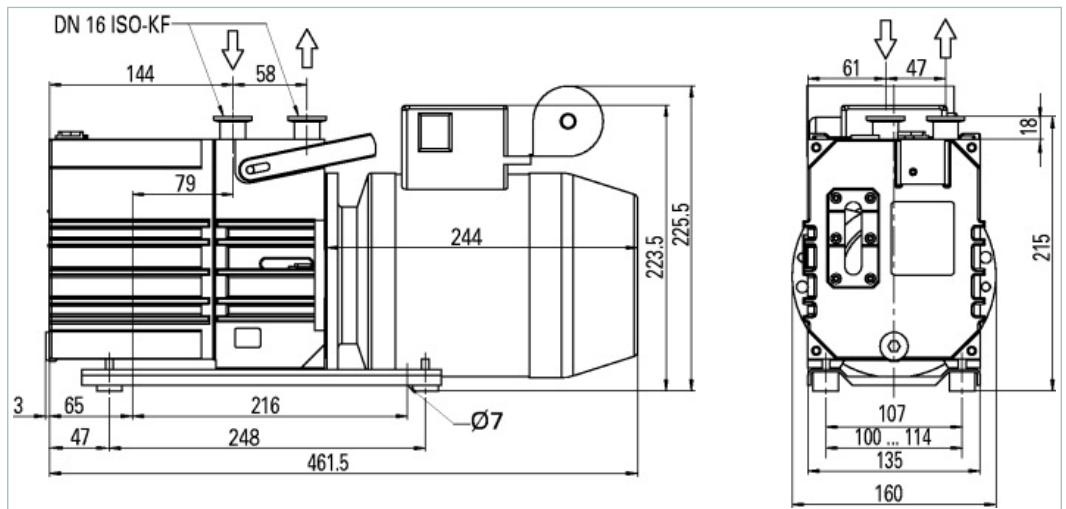

Technical Data	Duo 5 MC, 1-phase motor, 200-240 V, 50 Hz; 208-240 V, 60 Hz
Ambient temperature	12-40 °C   53.6-104 °F   285-313 K
Cooling method, standard	Air
Corrosive gas version	yes
Emission sound pressure level without gas ballast at 50 Hz	≤ 57 dB (A)
Exhaust pressure, max.	1,500 hPa   1,125 Torr   1,500 mbar
Exhaust pressure, min.	250 hPa   187.5 Torr   250 mbar
Flange (in)	DN 16 ISO-KF
Flange (out)	DN 16 ISO-KF
Leak rate magnetic coupling	≤ 1 · 10 <sup>-6</sup> Pa m <sup>3</sup> /s   ≤ 7.5 · 10 <sup>-6</sup> Torr l/s   ≤ 1 · 10 <sup>-5</sup> mbar l/s
Leak rate safety valve	≤ 1 · 10 <sup>-5</sup> Pa m <sup>3</sup> /s   ≤ 7.5 · 10 <sup>-5</sup> Torr l/s   ≤ 1 · 10 <sup>-4</sup> mbar l/s
Magnetic coupling	yes
Mains cable	yes
Mains requirement: voltage 50 Hz	200-240 (± 5 %) V
Mains requirement: voltage 60 Hz	208-240 (± 5 %) V
Motor version	1-phase Motor
Operating fluid	F4
Operating fluid filling	0.75 l
Protection category	IP 55
Pumping speed at 50 Hz	5 m <sup>3</sup> /h
Pumping speed at 60 Hz	6 m <sup>3</sup> /h
Rated power 50 Hz	0.37 kW
Rated power 60 Hz	0.37 kW
Rotation speed at 50 Hz	1500 min <sup>-1</sup>
Rotation speed at 60 Hz	1800 min <sup>-1</sup>
Switch	yes
Ultimate pressure with gas ballast	7 · 10 <sup>-3</sup> hPa   5.25 · 10 <sup>-3</sup> Torr   7 · 10 <sup>-3</sup> mbar
Ultimate pressure without gas ballast	4 · 10 <sup>-3</sup> hPa   3 · 10 <sup>-3</sup> Torr   4 · 10 <sup>-3</sup> mbar
Weight	25 kg   55.12 lb

Typical ultimate pressure according to PNEUROP

## Order number

Duo 5 M

PK D61 732

<b>Accessories</b>	
<b>Accessories</b>	
Oil return unit from ONF 25 M, 25 L, 25 XL	<b>PK 196 177 -T</b>
ONF 025 C, oil mist filter, corrosive gas version up to 24 m <sup>3</sup> /h	<b>PK Z40 406</b>
<b>Accessories UnoLine</b>	
Oil pressure switch for Duo 5/10/20 M and Penta 20/35	<b>PK 196 484 -T</b>
Operations monitoring unit 1 for Duo 1.6/3/6/11 and Duo 5/10/20 M	<b>PK 196 157 -T</b>
Operations monitoring unit 2 for Duo 1.6/3/6/11 and Duo 5/10/20 M	<b>PK 196 142 -T</b>
Operations monitoring unit 3 for Duo 1.6/3/6/11 and Duo 5/10/20 M	<b>PK 196 141 -T</b>
<b>Accessories UnoLine Plus</b>	
PTC-resistor tripping device	<b>P 4768 051 FQ</b>
<b>Consumables</b>	
F4, Perfluoropolyether, 0.25 l	<b>PK 005 885 -T</b>
F4, Perfluoropolyether, 0.5 l	<b>PK 005 886 -T</b>
F4, Perfluoropolyether, 1 l	<b>PK 005 887 -T</b>