



# Duo 125/M

Dual-stage rotary vane pumps with a pumping speed up to 135 m<sup>3</sup>/h:





Similar Image

## Duo 125, 3-phase motor, 3TF, 220/380 V, 60 Hz

- Dual-stage, high-performance rotary vane pump with a pumping speed up to 135 m<sup>3</sup>/h
- With 3-phase motor
- With temperature sensor (3TF) for optimum motor protection
- Integrated gas ballast and HV safety valve
- For all low and medium vacuum applications
- Special feature: Various motor voltages for wide application field
- Other motor voltages available on request

TF = Temperature sensor

M = Magnetic coupling

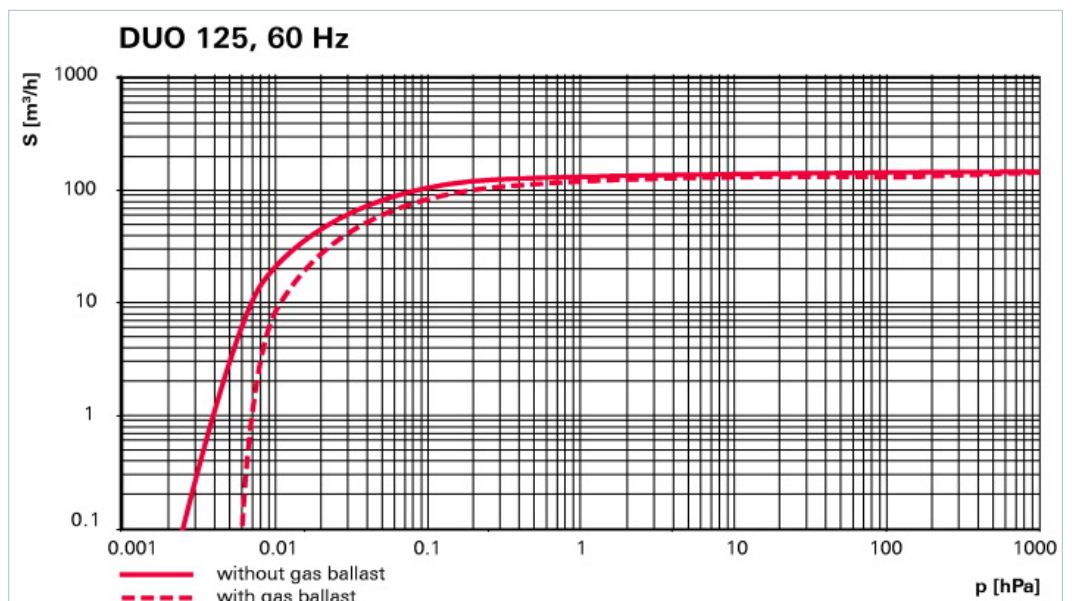
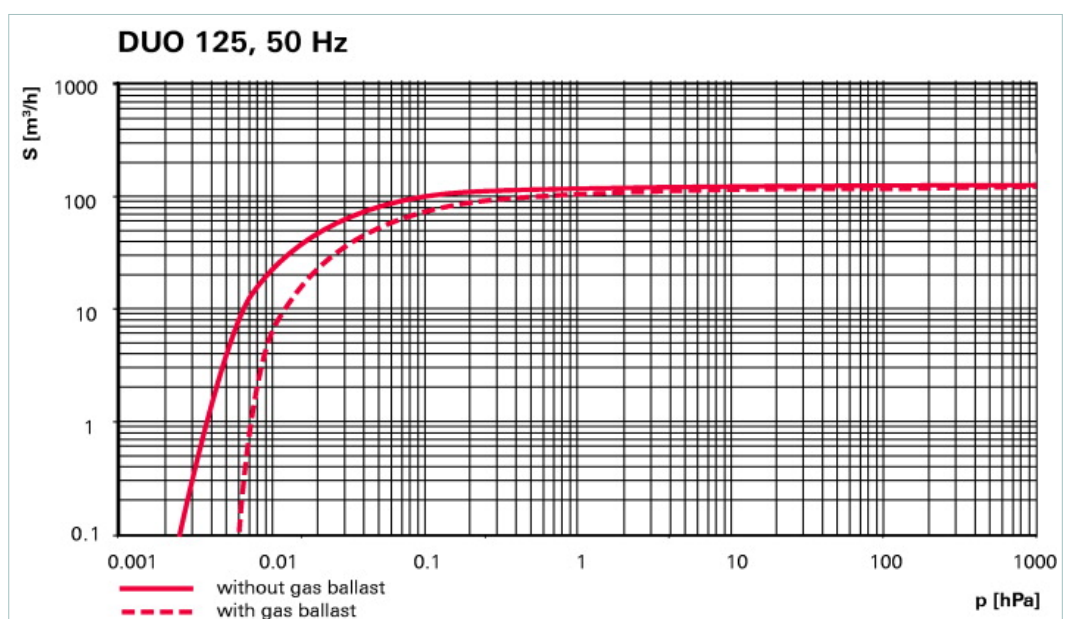

## Dimensions

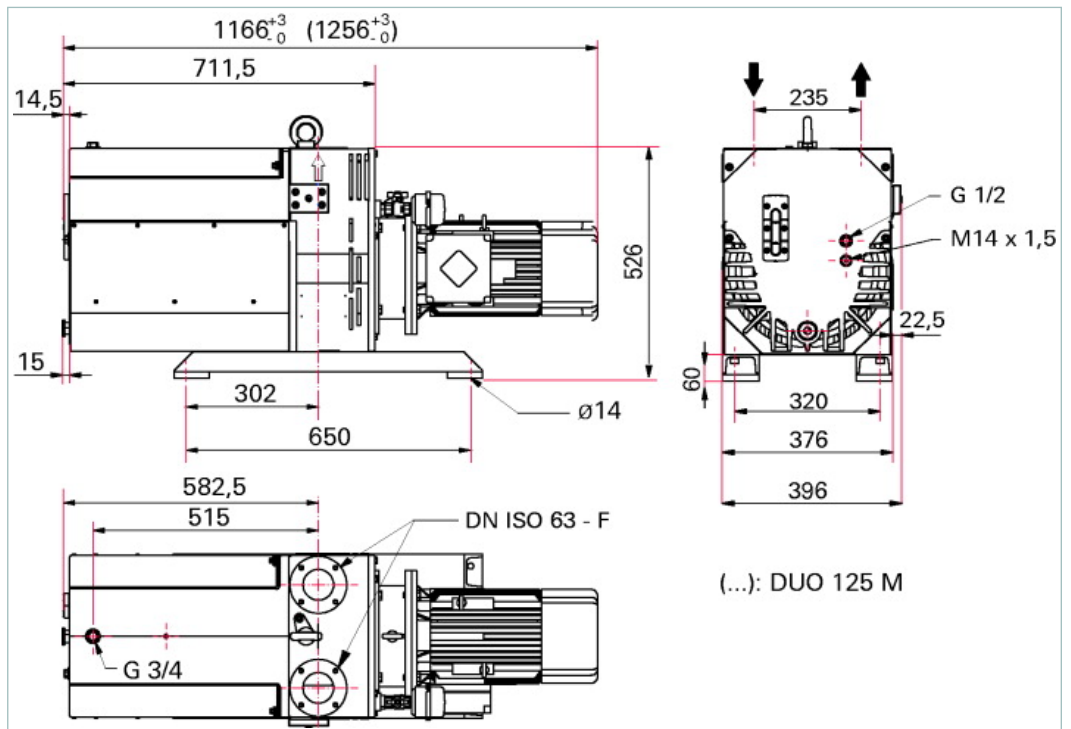

Technical Data	Duo 125, 3-phase motor, 3TF, 220/380 V, 60 Hz
Ambient temperature	12-40 °C   53.6-104 °F   285-313 K
Cooling method, standard	Air
Emission sound pressure level without gas ballast at 50 Hz	75 dB (A)
Exhaust pressure, max.	1,500 hPa   1,125 Torr   1,500 mbar
Exhaust pressure, min.	250 hPa   187.5 Torr   250 mbar
Flange (in)	DN 63 ISO-F
Flange (out)	DN 63 ISO-F
Leak rate safety valve	$\leq 1 \cdot 10^{-5} \text{ Pa m}^3/\text{s}$   $\leq 7.5 \cdot 10^{-5} \text{ Torr l/s}$   $\leq 1 \cdot 10^{-4} \text{ mbar l/s}$
Mains requirement: voltage 60 Hz	220/380 V
Motor protection	3TF
Motor version	3-phase Motor
Operating fluid	P3
Operating fluid filling	13 l
Protection category	IP 55
Pumping speed at 60 Hz	140 m <sup>3</sup> /h
Rated power 60 Hz	4 kW
Rotation speed at 60 Hz	1200 min <sup>-1</sup>
Ultimate pressure with gas ballast	$4 \cdot 10^{-3} \text{ hPa}$   $3 \cdot 10^{-3} \text{ Torr}$   $4 \cdot 10^{-3} \text{ mbar}$
Ultimate pressure without gas ballast	$2 \cdot 10^{-3} \text{ hPa}$   $1.5 \cdot 10^{-3} \text{ Torr}$   $2 \cdot 10^{-3} \text{ mbar}$
Weight	245 kg   540.13 lb

Typical ultimate pressure according to PNEUROP

## Order number

Duo 125/M

PK D47 652

Accessories	
<b>Accessories</b>	
Heating rod for ZFO 063, 220 V, 50/60 Hz	PK Z90 030 A
KAS 63, condensate separator for pumping speeds up to 250 m <sup>3</sup> /h	PK Z10 010
KLF 063, cold trap	PK Z80 010
OFM 125, mechanical oil filter	PK Z90 340
Oil level monitoring 20-250 V AC for Okta 250 / M / Okta 500 / M / Okta 1000 / M / Okta 2000 / M / Okta 4000 / M / Okta 6000 / M, G 1 1/4	PK 004 930 -U
Oil level monitoring 24 V DC for Okta 250 / M / Okta 500 / M / Okta 1000 / M / Okta 2000 / M / Okta 4000 / M / Okta 6000 / M, G 1 1/4	PK 005 639 -U
Oil pressure switch for Duo 125/255	PK 223 806 -T
ONF 63, oil mist filter for pumping speeds of up to 135 m <sup>3</sup> /h	PK Z40 010
Operating fluid level monitoring	PK 006 001 -T
Operations monitoring unit 3 for Duo 35/65, Duo 125/255	PK 223 739 -U
Temperature sensor for operating fluid	PK 006 040 -T
ZFO 063, zeolite trap	PK Z70 010
<b>Accessories HenaLine</b>	
SAS 63 dust separator, DN 63 ISO-K, polyester filter	PK Z60 511
<b>Accessories UnoLine Plus</b>	
FAK 063, activated carbon filter	PK Z30 010
Oil return unit, ORF 005, standard version	PK Z90 065
PTC-resistor tripping device	P 4768 051 FQ
<b>Consumables</b>	
P3, mineral oil, 1 l	PK 001 106 -T
P3, mineral oil, 5 l	PK 001 107 -T
P3, mineral oil, 20 l	PK 001 108 -T