



HiPace[®] 300 with TC 400, Profibus, DN 100 ISO- K





Similar Image

HiPace® 300 with TC 400, Profibus, DN 100 ISO- K

- Rugged, powerful turbopump with a pumping speed of up to 260 l/s for N₂
- Integrated drive electronics TC 400 with Profibus
- Ideal for analytical and industrial applications
- For installation in any orientation
- With integrated water cooling for maximum gas throughput
- Flexible through the ability to employ up to 4 accessories
- Profibus connection with M12-plug-in connector
- Ideal for fast cycles
- Extensive accessories expand the range of applications
- Corrosive gas version on request

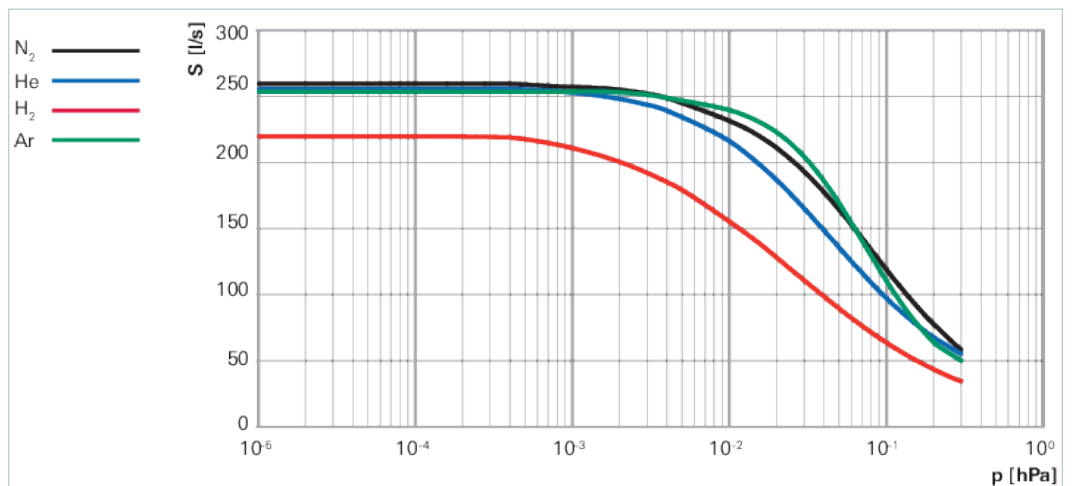

Dimensions

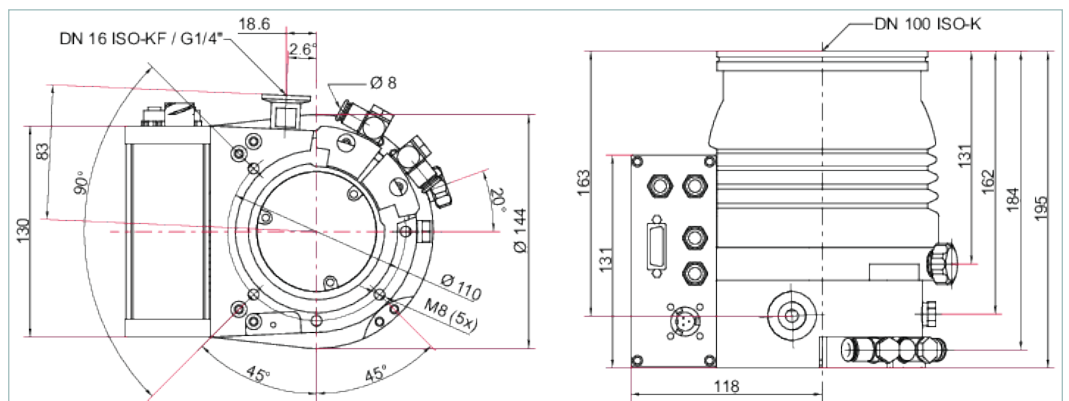

Technical Data	HiPace® 300 with TC 400, Profibus, DN 100 ISO- K
Bearing	Hybrid
Compression ratio for Ar	$> 1 \cdot 10^{11}$
Compression ratio for H ₂	$9 \cdot 10^5$
Compression ratio for He	$> 1 \cdot 10^8$
Compression ratio for N ₂	$> 1 \cdot 10^{11}$
Connection flange (in)	DN 100 ISO-K
Connection flange (out)	DN 16 ISO-KF/G 1/4"
Cooling method, optional	Air
Cooling method, standard	Water

Technical Data	HiPace® 300 with TC 400, Profibus, DN 100 ISO- K
Cooling water flow	50 l/h
Cooling water flow, max.	50 l/h
Cooling water flow, min.	50 l/h
Cooling water temperature	15-35 °C 59-95 °F 288-308 K
Current max.	12,5 A
Electronic drive unit	with TC 400
Final pressure without gas ballast	$< 1 \cdot 10^{-7}$ hPa $< 7.5 \cdot 10^{-8}$ Torr $< 1 \cdot 10^{-7}$ mbar
Fore-vacuum max. for N ₂	20 hPa 15 Torr 20 mbar
Gas throughput at full rotational speed for Ar	7 hPa·l/s
Gas throughput at full rotational speed for H ₂	> 14 hPa·l/s
Gas throughput at full rotational speed for He	20 hPa·l/s
Gas throughput at full rotational speed for N ₂	14 hPa·l/s
I/O interfaces	RS-485, Remote, Profibus
Interface, extended	Profibus
Mounting orientation	Any
Operating voltage: V DC	24 (± 5 %) V DC
Permissible radial magnetic field max.	5.5 mT
Power consumption max.	300 W
Protection category	IP54
Pumping speed for Ar	255 l/s
Pumping speed for H ₂	220 l/s
Pumping speed for He	255 l/s
Pumping speed for N ₂	260 l/s
Rotation speed ± 2 %	60,000 rpm 60,000 min ⁻¹
Run-up time	1.8 min
Sound pressure level	≤50 dB(A)
Ultimate pressure according to PNEUROP	$< 1 \cdot 10^{-7}$ hPa $< 7.5 \cdot 10^{-8}$ Torr $< 1 \cdot 10^{-7}$ mbar
Venting connection	G 1/8"
Weight	6.7 kg 14.77 lb

Order number	
HiPace® 300	PM P04 230

Accessories	
Adapters (electrical) Profibus	
Y-Connector M12B to Profibus	P 4723 015
Y-Connector with cable M12B to Profibus, 0.5 m	P 4723 018
T-Connector M12B to Profibus	P 4723 020
Termination resistor M12B for Profibus	P 4723 030
Plug and socket M12B for Profibus	PM 051 927 -T
Remote adapter for RS-485	PM 061 649 -X
Line filter for cable fitting	PM 061 806
Adapters (electrical) Remote	
Y-Connector, shielded, M12 for accessories	P 4723 013
Supply socket TC 400/TM 700, straight	P 4723 100
Supply bushing, angled, for TC 400/TM 700	P 4723 101
Adapters (electrical) RS-232/485	
Y-distributor M12 to RS-485	P 4723 010
USB RS-485 converter	PM 061 207 -T
Coupling M12 for RS-485	PM 061 270 -X
Termination resistor for RS-485	PT 348 105 -T
Power separator for RS-485	PT 348 132 -T
Cables Backing pump control cables	
Control cable for pumping stations 0.7 m	PM 061 675 AT
HiPace – ACP connection cable	PM 071 142 -X
Cables Connection cables	
Connection cable for HiPace with TC 400/TM 700 to power supply pack TPS/DCU 310/311/400/401	PM 061 352 -T
Cables Extension cables	
Extension cable M12 on M12	PM 061 747 -T
Cables Mains cables / Power cords	
Mains cable 230 V AC, CEE 7/7 to C13, 3 m	P 4564 309 ZA
Mains cable 115 V AC, NEMA 5-15 to C13, 3 m	P 4564 309 ZE
Mains cable 208 V AC, NEMA 6-15 to C13, 3 m	P 4564 309 ZF
Cables RS-485 Interface cables	
Interface cable, M12 m straight/M12 m straight, 3 m	PM 061 283 -T
Interface cable, M12 m straight/ M12 m angled, 0.7 m	PM 061 791 -T
Control Devices Backing pump	
Relay box for backing pumps, single phase 20 A for TC 400 and TCP 350, M12 plug	PM 061 375 -T
Relay box, shielded, for backing pumps, 1-phase 7 A for TC 400/1200, TM 700 and TCP 350, M12	PM 071 284 -X
Relay box, shielded, for backing pumps, 1-phase 20 A for TC 400/1200, TM 700 and TCP 350, M12	PM 071 285 -X
Control Devices Power supplies and control displays	
HPU 001, Handheld Programming Unit	PM 051 510 -T
Accessories package for HPU 001/PC	PM 061 005 -T
TPS 310, power supply pack for wall/standard rail fitting	PM 061 342 -T
TPS 311, power supply pack 3HU 19" rack module	PM 061 346 -T
DCU 002, Display Control Unit	PM 061 348 AT
Front panel kit for TPS 311	PM 061 395 -T
DCU 310, Display control unit with power supply pack	PM C01 822

Accessories	
Cooling Air cooling	
Air cooling for HiPace 300 with TC 400	PM Z01 302
Air cooling for HiPace 300, 115 V	PM Z01 308
Air cooling for HiPace 300, 230 V	PM Z01 309
Monitoring Pressure Sensors	
RPT 010, digital Piezo/Pirani sensor	PT R71 100
IKT 010, digital cold cathode sensor, low current	PT R72 100
IKT 011, digital cold cathode sensor, high current	PT R73 100
Monitoring Sealing gas monitoring units	
Sealing gas monitoring unit G 1/8"	PM 016 911 -U
Mounting DN ISO-K, Mounting kits, bracket screws	
Mounting kit for HiPace 300 with DN 100 ISO-K, including coated centering ring and bracket screws	PM 016 365 -T
Mounting kit for HiPace 300, DN 100 ISO-K, including coated centering ring, splinter shield and bracket screws	PM 016 366 -T
Mounting kit for HiPace 300, DN 100 ISO-K, including coated centering ring, protection screen and bracket screws	PM 016 367 -T
Mounting DN ISO-K/-F, sealings	
Centering ring with multifunction coating, DN 100 ISO-K/-F	PM 016 210 -U
Mounting DN ISO-K/-F Mounting kits	
Mounting kit for DN 100 ISO-K to ISO-F, with collar flange, coated centering ring, hexagon bolts	PM 016 940 -T
Mounting kit for DN 100 ISO-K to ISO-F, with collar flange, coated centering ring with splinter shield, hexagon bolts	PM 016 941 -T
Mounting kit for DN 100 ISO-K to ISO-F, with collar flange, coated centering ring with protection screen, hexagon bolts	PM 016 942 -T
Mounting kit for DN 100 ISO-K to ISO-F, with collar flange, coated centering ring, stud screws	PM 016 945 -T
Mounting kit for DN 100 ISO-K to ISO-F, with collar flange, coated centering ring with splinter shield, stud screws	PM 016 946 -T
Mounting kit for DN 100 ISO-K to ISO-F, with collar flange, coated centering ring with protection screen, stud screws	PM 016 947 -T
Mounting Wall rail fittings	
Wall rail fitting for TPS 110/180/310/400	PM 061 392 -T
Other	
TIC 010, adapter for two sensors	PT R70 000
Protection DN ISO-K/-F, sealings, splinter shields, protection screens	
Centering ring with multifunction coating and integrated splinter shield, DN 100 ISO-K/-F	PM 016 211 AU
Centering ring with multifunction coating and integrated protection screen, DN 100 ISO-K/-F	PM 016 212 AU
Protection Sealing gas throttles	
Sealing gas throttle for HiPace 300	PM Z01 317
Valves Fore-vacuum safety valves	
TVV 001, fore-vacuum safety valve, 230 V AC	PM Z01 205
TVV 001, fore-vacuum safety valve, 115 V AC	PM Z01 206

Accessories	
Valves Sealing gas valves, shielded (normally closed)	
Sealing gas valve, shielded for HiPace 300 with TC 400 and TM 700, TCP 350	PM Z01 312
Venting Power failure venting units (normally open)	
Power failure venting valve, shielded, 24 V DC, G 1/8" for connection to TC 400, TM 700 and TC 1200	PM Z01 331
Venting Venting accessories	
Flange with Pipe Thread, DN 16 ISO-KF, G 1/8"	PM 016 780 -T
Push-in fitting for 6 mm tube, G 1/8"	PM 016 781 -T
Push-in fitting for 8 mm tube, G 1/8"	PM 016 782 -T
Hose nozzle for 9 mm hose, G 1/8"	PM 016 783 -T
Banjo fitting	PM 016 787 -T
Screw-in flange, DN 10 ISO-KF, G 1/8"	PM 033 737 -T
Banjo fitting, small	PM 143 877 -T
TTV 001, Drier for Venting Turbopumps	PM Z00 121
Venting Venting valves (normally closed)	
Venting valve, shielded, 24 V DC, G 1/8", for connection to TC 400/1200 and TM 700	PM Z01 291
Venting valve, shielded, 24 V DC, G1/8" for connecting to TC 400, 1200 as well as TM 700 with an 270° angled plug	PM Z01 292
Vibration Reduction Vibration dampers	
Vibration damper for HiPace 300/400, DN 100 ISO-K/F	PM 006 459 AX



伯东企业（上海）有限公司
HAKUTO ENTERPRISES (SHANGHAI) LTD.
TEL: (86) 21-5046 3511 TEL: (86) 21-5046 1322

上海伯东 -- 您理想的真空合作伙伴！

伯东公司成立于 1953 年，外企上市企业，全球范围内有一千七百名员工，集团年营业额约为 100亿人民币。

伯东公司在国内主要城市：上海，北京，苏州，广州，深圳，成都及厦门设有营业据点。

上海伯东真空产品事业部已累计为超过 10,000 家企业提供真空服务

我们致力于追求高品质的服务，为您提供一流的服务及一流产品：

品质保障：国际知名品牌指定授权代理商，所有产品及部件保证 100% 原厂原装进口

现货交期快：部分产品有现货，下单立即发货（现货数量有限，实际情况请联系销售工程师）

卓越维修能力：伯东工程师拥有10年以上维修经验，且受国外专业培训，拥有完全的拆解，维修，校正能力。

完美服务质量：原装进口检测设备全方位寻找问题症结及全方面的性能测试，确保完美的服务质量



伯东企业（上海）有限公司 销售及售后服务中心

上海浦东新区新金桥路1888号36号楼7楼702室

电 话：+86-21-5046-3511 / 139-1883-7267

传 真：+86-21-5046-1490

官 网：<http://www.hakuto-vacuum.cn>



伯东企业（上海）有限公司 深圳办事处 销售中心

深圳市罗湖区宝安南路1036号鼎丰大厦501

电 话：+86- 0755-2547-3988. 643

传 真：+86-21-5046-1490

伯东企业（上海）有限公司 北京办事处 销售中心

北京丰台区芳群园四区22号楼金城中心705室

电 话：+86- 010-8768-4988

传 真：+86-21-5046-1490