



HiPace® 300

Compact yet powerful turbopumps with pumping speeds of up to 260 l/s for N₂





Similar Image

HiPace® 300 with TC 110 and power supply OPS 100, DN 100 ISO-K

- Rugged, powerful turbopump with a pumping speed of up to 260 l/s für N₂
- DN 100 ISO-K flange
- Drive electronics TC 110 and power supply OPS 100 integrated
- Ideal for analytical and industrial applications
- For installation in any orientation
- Extensive accessories expand the range of applications

C=Corrosive gas version

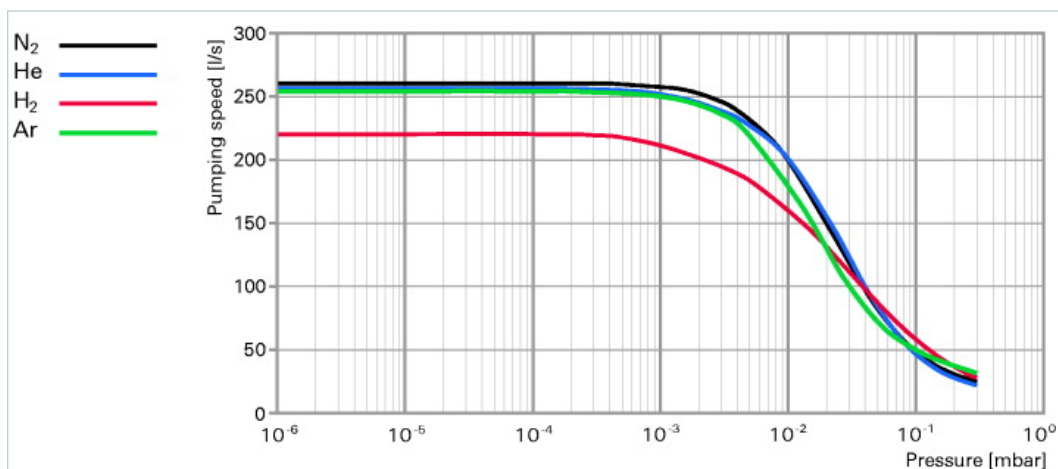

Dimensions

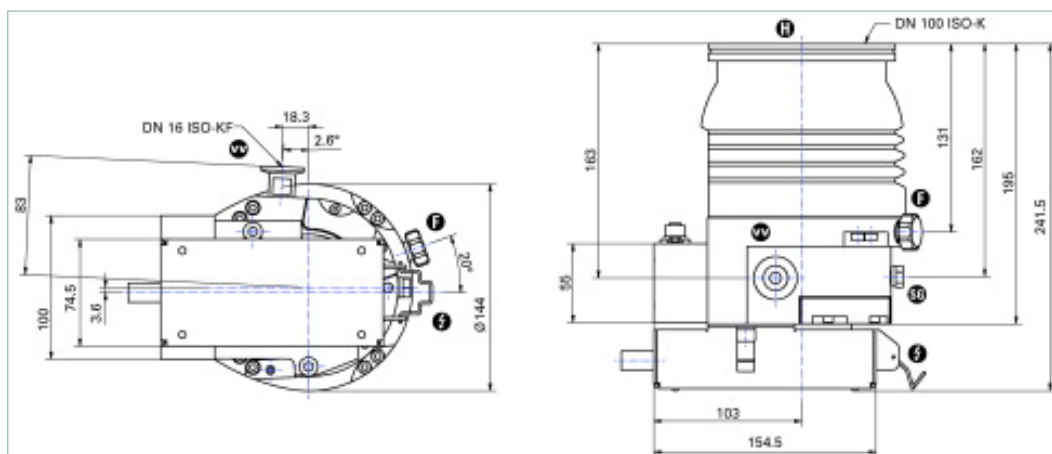

Technical Data	HiPace® 300 with TC 110 and power supply OPS 100, DN 100 ISO-K
Bearing	Hybrid
Compression ratio for Ar	$> 1 \cdot 10^{11}$
Compression ratio for H ₂	$9 \cdot 10^5$
Compression ratio for He	$> 1 \cdot 10^8$
Compression ratio for N ₂	$> 1 \cdot 10^{11}$
Cooling method, optional	Air
Electronic drive unit	with TC 110
Flange (in)	DN 100 ISO-K
Flange (out)	DN 16 ISO-KF / G 1/4"

Technical Data		HiPace® 300 with TC 110 and power supply OPS 100, DN 100 ISO-K	
Fore-vacuum max. for N ₂		11 hPa 8.25 Torr 11 mbar	
Gas throughput at full rotational speed for Ar		0.5 hPa l/s 0.38 Torr l/s 0.5 mbar l/s	
Gas throughput at full rotational speed for H ₂		5 hPa l/s 3.75 Torr l/s 5 mbar l/s	
Gas throughput at full rotational speed for He		1.8 hPa l/s 1.35 Torr l/s 1.8 mbar l/s	
Gas throughput at full rotational speed for N ₂		0.9 hPa l/s 0.68 Torr l/s 0.9 mbar l/s	
Integrated power supply		yes	
Interfaces		RS-485, Remote	
Mounting orientation		in any orientation	
Operating voltage		24 (± 5 %) V DC	
Permissible magnetic field max.		5.5 mT	
Protection category		IP30	
Pumping speed for Ar		255 l/s	
Pumping speed for H ₂		220 l/s	
Pumping speed for He		255 l/s	
Pumping speed for N ₂		260 l/s	
Rotation speed ± 2 %		60000 min ⁻¹	
Rotation speed variable		35-100 %	
Run-up time		4 min	
Sound pressure level		≤ 50 dB (A)	
Ultimate pressure according to PNEUROP		< 1 · 10 ⁻⁷ hPa < 7.5 · 10 ⁻⁸ Torr < 1 · 10 ⁻⁷ mbar	
Venting connection		G 1/8"	
Weight		6.9 kg 15.21 lb	
Order number			
HiPace® 300		PM P04 330	

Accessories	
Accessory for TC 110	
TCS 11, adapter for TC 110/120 with RS-485 interface	PM 061 636 -U
TCS 12, adapter for TC 110/120 with interface RS-485, 4 accessory ports and coupling set	PM 061 638 -U
TCS 13, adapter for TC 110/120 with interface RS-485, 2 accessory ports and coupling set	PM 061 856 -U
Adapter and control cables	
Control cable for valve	PM 061 687 -T
HiPace - ACP connection cable	PM 071 142 -X
Air cooling	
Air cooling for HiPace 300/450, 115 V	PM Z01 308
Air cooling for HiPace 300/450, 230 V	PM Z01 309
Air cooling for HiPace 300/450 with TC 110/120	PM Z01 301
Control and display units	
Accessories package for HPU 001/PC	PM 061 005 -T
DCU 002, Display Control Unit	PM 061 348 -T
HPU 001, Handheld Programming Unit	PM 051 510 -T
RJ 45 interface cable on M12 for HiPace	PM 051 726 -T
DN ISO-K, Mounting kit, bracket screws	
Mounting kit for HiPace 300, DN 100 ISO-K, including coated centering ring, protection screen and bracket screws	PM 016 367 -T
Mounting kit for HiPace 300, DN 100 ISO-K, including coated centering ring, splinter shield and bracket screws	PM 016 366 -T
Mounting kit for HiPace 300 with DN 100 ISO-K, including coated centering ring and bracket screws	PM 016 365 -T
DN ISO-K / -F, sealings, splinter shields, protection screens	
Centering ring with multifunction coating, DN 100 ISO-K/-F	PM 016 210 -U
Centering ring with multifunction coating and integrated protection screen, DN 100 ISO-K/-F	PM 016 212 -U
Centering ring with multifunction coating and integrated splinter shield, DN 100 ISO-K/-F	PM 016 211 -U
Fore-vacuum safety valves	
TVV 001 fore-vacuum safety valve, 115 V AC	PM Z01 206
TVV 001 fore-vacuum safety valve, 230 V AC	PM Z01 205
Interface and extension cables	
Interface cable, M12 m straight/ M12 m angled 0.7 m	PM 061 791 -T
Interface cable, M12 m straight / M12 m straight, 3 m	PM 061 283 -T
Mains cables	
Mains cable 115 V AC, NEMA 5-15 to C13, 3 m	P 4564 309 ZE
Mains cable 208 V AC, NEMA 6-15 to C13, 3 m	P 4564 309 ZF
Mains cable 230 V AC, CEE 7/7 to C13, 3 m	P 4564 309 ZA
Power failure venting units (normally open)	
Shielded power failure venting unit, 24 V DC, G 1/8", for connection to TC 110/120	PM Z01 330
Relay boxes	
Relay box, shielded, for backing pumps, 1-phase 7A for TC 110/120 and TCP 350, plug M8	PM 071 282 -X
Relay box for backing pump, single phase 20 A for TC 110/120 and TCP 350, M8 plug	PM 061 373 -T

Accessories	
RS-485	
Connector M12 to RS-485	PM 061 270 -X
Power separator for RS-485	PT 348 132 -T
Termination resistor for RS-485	PT 348 105 -T
USB converter to RS-485 interface	PM 061 207 -T
Y-Connector M12 to RS-485	P 4723 010
Sealing gas	
Sealing gas throttle for HiPace 300 - 800	PM Z01 317
Sealing gas valve, shielded for HiPace 300/450 with TC 110/120	PM Z01 311
Venting accessory with small flange, G 1/8", hoses, air drier	
Banjo fitting	PM 016 787 -T
Banjo fitting, small	PM 143 877 -T
Hose nozzle for 9 mm hose, G 1/8"	PM 016 783 -T
Push-in fitting for 6 mm hose, G 1/8"	PM 016 781 -T
Push-in fitting for 8 mm hose, G 1/8"	PM 016 782 -T
Screw-in flange, DN 10 ISO-KF, G 1/8"	PM 033 737 -T
Screw-on flange, DN 16 ISO-KF, G 1/8"	PM 016 780 -T
TTV 001, dryer for venting turbopumps	PM Z00 121
Venting valve (normally closed)	
Venting valve, shielded, 24 V DC, G 1/8", for connection to TC 110/120	PM Z01 290
Vibration damper	
Vibration damper for HiPace 300/400, DN 100 ISO-K/F	PM 006 459 -X