



HiPace[®] 1200

Powerful turbopumps with pumping speeds of
up to 1,300 l/s.





Similar Image

HiPace® 1200 U with TC 1200, DN 200 ISO-F, upside down version

- Powerful turbopump with a pumping speed of up to 1250 l/s for N₂
- DN 200 ISO-F flange
- Integrated TC 1200 drive electronics with power supply
- Cooling: Water cooling
- Installation orientation: Upside-down (90° - 180°)
- Integrated sealing gas system with electric sealing gas valve 24 V DC
- Protection Class: IP 54
- Interfaces: RS-485, Remote (Profibus/DeviceNet on request)
- Extensive accessories expand the range of applications

C = Corrosive gas version

U = Upside-down installation orientation

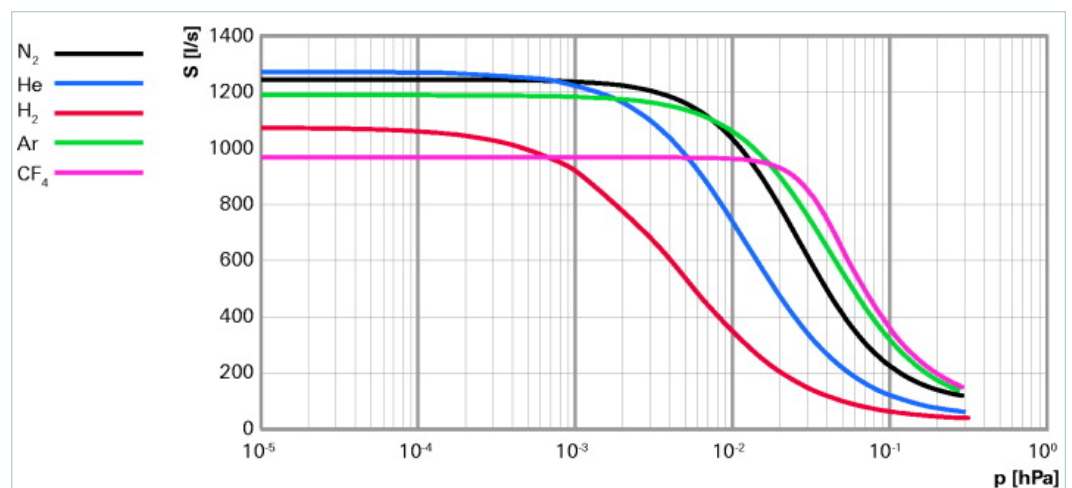

Dimensions

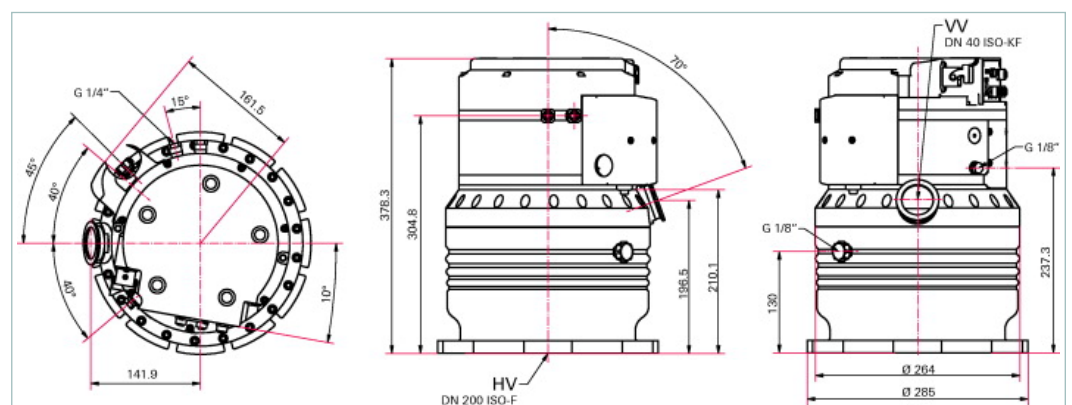

Technical Data

HiPace® 1200 U with TC 1200, DN 200 ISO-F, upside down version

Bearing	Hybrid
Compression ratio for Ar	$> 1 \cdot 10^8$
Compression ratio for H ₂	$6 \cdot 10^3$
Compression ratio for He	$2 \cdot 10^5$
Compression ratio for N ₂	$> 1 \cdot 10^8$
Cooling method, standard	Water
Cooling water consumption	100 l/h
Cooling water temperature	15-35 °C 59-95 °F 288-308 K

Technical Data		HiPace® 1200 U with TC 1200, DN 200 ISO-F, upside down version	
Electronic drive unit	with TC 1200		
Flange (in)	DN 200 ISO-F		
Flange (out)	DN 40 ISO-KF		
Fore-vacuum max. for N ₂	2 hPa 1.5 Torr 2 mbar		
Gas throughput at full rotational speed for Ar	11 hPa l/s 8.25 Torr l/s 11 mbar l/s		
Gas throughput at full rotational speed for H ₂	> 30 hPa l/s > 22.5 Torr l/s > 30 mbar l/s		
Gas throughput at full rotational speed for He	> 30 hPa l/s > 22.5 Torr l/s > 30 mbar l/s		
Gas throughput at full rotational speed for N ₂	20 hPa l/s 15 Torr l/s 20 mbar l/s		
Integrated power supply	yes		
Interfaces	RS-485, Remote		
Mounting orientation	Upside down (90°-180°)		
Operating voltage	100-120/200-240 V AC, 50/60 Hz		
Particulate matter	yes		
Permissible magnetic field max.	6 mT		
Protection category	IP 54		
Pumping speed for Ar	1200 l/s		
Pumping speed for H ₂	1100 l/s		
Pumping speed for He	1300 l/s		
Pumping speed for N ₂	1250 l/s		
Rotation speed ± 2 %	37800 min ⁻¹		
Rotation speed variable	50-100 %		
Run-up time	2.5 min		
Sound pressure level	50 dB (A)		
Ultimate pressure according to PNEUROP	< 1 · 10 ⁻⁷ hPa < 7.5 · 10 ⁻⁸ Torr < 1 · 10 ⁻⁷ mbar		
Venting connection	G 1/8"		
Weight	28 kg 61.73 lb		
Order number			
HiPace® 1200		PM P03 914	

Accessories	
Accessory for TC 400/1200 and TM 700	
Y-connector, shielded, M12 for accessories	P 4723 013
Adapter and control cables	
Control cable for pumping stations 0.7 m	PM 061 675 AT
HiPace - ACP connection cable	PM 071 142 -X
Control and display units	
Accessories package for HPU 001/PC	PM 061 005 -T
DCU 002, Display Control Unit	PM 061 348 -T
HPU 001, Handheld Programming Unit	PM 051 510 -T
DN ISO-F, Mounting kit	
Mounting kit for DN 200 ISO-F, including coated centering ring, protective screen, hexagon screws	PM 016 472 -T
Mounting kit for DN 200 ISO-F, including coated centering ring, protective screen, stud screws	PM 016 477 -T
Mounting kit for DN 200 ISO-F, including coated centering ring, splinter shield, stud screws	PM 016 476 -T
Mounting kit for DN 200 ISO-F, including coated centering ring, stud screws	PM 016 475 -T
Mounting kit for HiPace 1200/1800, DN 200 ISO-F, including coated centering ring, splinter shield, hexagon screws	PM 016 471 -T
Mounting kit for HiPace DN 200 ISO-F, including coated centering ring, hexagon screws	PM 016 470 -T
DN ISO-K / -F, sealings, splinter shields, protection screens	
Centering ring with multifunction coating, DN 200 ISO-K/-F	PM 016 220 -U
Centering ring with multifunction coating and integrated protection screen, DN 200 ISO-K/-F	PM 016 222 -U
Centering ring with multifunction coating and integrated splinter shield, DN 200 ISO-K/-F	PM 016 221 -U
Fore-vacuum safety valves	
TVV 001 fore-vacuum safety valve, 115 V AC	PM Z01 206
TVV 001 fore-vacuum safety valve, 230 V AC	PM Z01 205
Interface and extension cables	
Interface cable, M12 m straight / M12 m straight, 3 m	PM 061 283 -T
Mains cables	
Mains cable 115 V AC, NEMA 5-15 to HAN 3A, 3 m	PM 061 187 -X
Mains cable 208 V AC, NEMA 6-15 to HAN 3A, 3 m	P 4564 309 HB
Mains cable 230 V AC, CEE 7/7 to HAN 3A, 3 m	P 4564 309 HA
Relay boxes	
Relay box, shielded, for backing pumps, 1-phase 20 A for TC 400/1200, TM 700 and TCP 350, M12	PM 071 285 -X
Relay box, shielded, for backing pumps, 1-phase 7 A for TC 400/1200, TM 700 and TCP 350, M12	PM 071 284 -X
RS-485	
Connector M12 to RS-485	PM 061 270 -X
Power separator for RS-485	PT 348 132 -T
Termination resistor for RS-485	PT 348 105 -T
USB converter to RS-485 interface	PM 061 207 -T
Y-Connector M12 to RS-485	P 4723 010

Accessories	
Sealing gas	
Sealing gas throttle for 1200–2300, 52.5 ± 7.5 sccm	PM Z01 325
Sealing gas throttle for HiPace 1200 - 2300	PM Z01 319
Sealing gas throttle for HiPace 400/700/800 P and C version and HiPace 1200 - 2300	PM Z01 318
Sealing gas valve, shielded, HiPace 400/700/800 P and C with TC 400 and HiPace 1200 - 2300 with TC 1200	PM Z01 313
Venting accessory with small flange, G 1/8", hoses, air drier	
TTV 001, dryer for venting turbopumps	PM Z00 121
Venting valve (normally closed)	
Venting valve, shielded, 24 V DC, G 1/8", for connection to TC 400/1200 and TM 700	PM Z01 291
Vibration damper	
Vibration damper for HiPace 800/1200/1800, DN 200 ISO-K/F	PM 006 668 -X