



**CMR 361, 1000 hPa F.S.,
DN 16 ISO-KF**





Similar Image

CMR 361, 1000 hPa F.S., DN 16 ISO-KF

- Precise pressure measurement independent of type of gas
- Measurement range up to four decades
- Gauge for connection to TPG
- Flange size: DN 16 ISO-KF
- Measurement range from $1 \cdot 10^{-1}$ hPa to 1100 hPa
- Minimal zero drift
- Sensor in ceramic technology
- No memory effects
- Materials employed have identical temperature coefficients
- Precise temperature compensation
- Calibration test report included in delivery

Dimensions

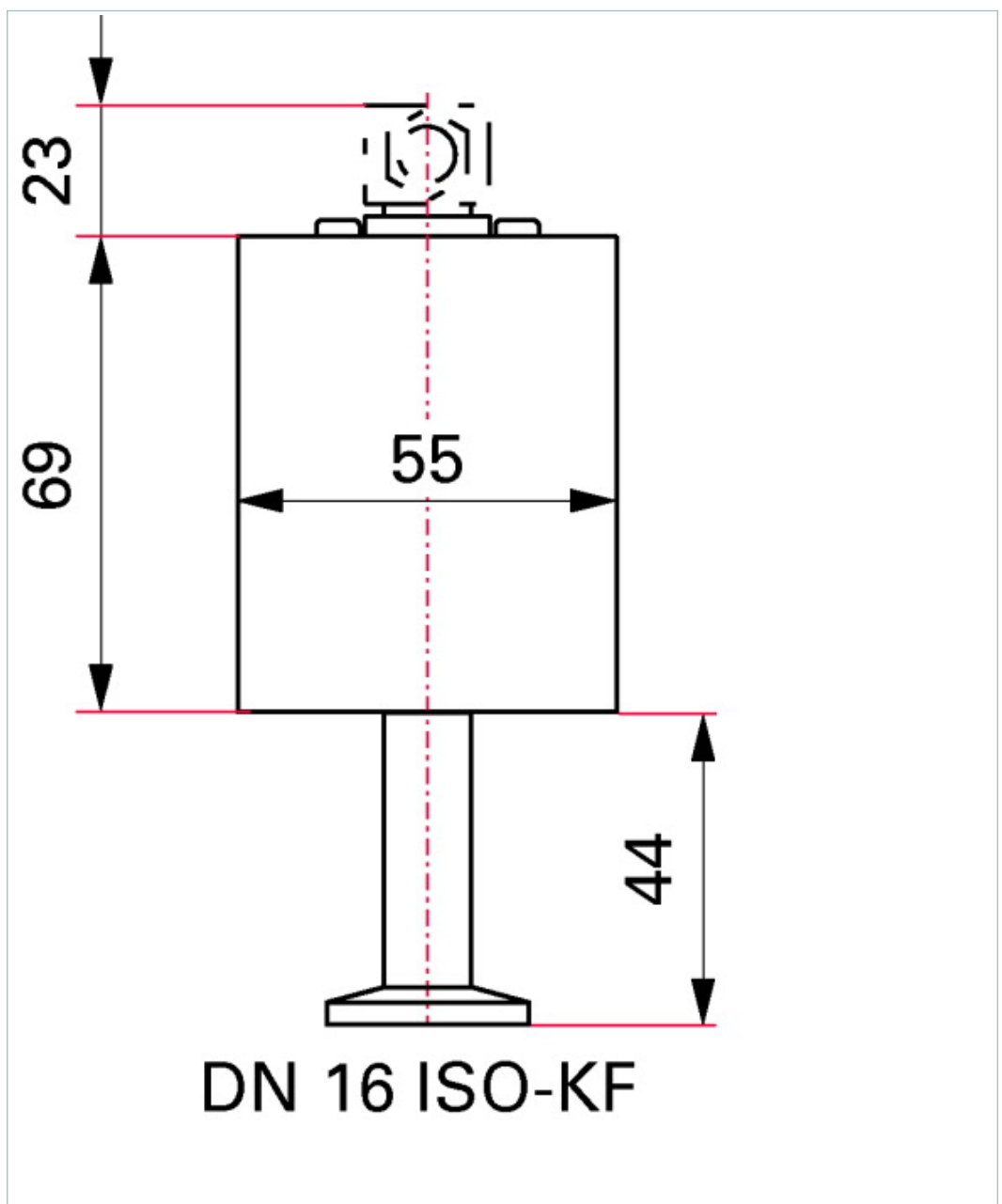

Technical Data	CMR 361, 1000 hPa F.S., DN 16 ISO-KF
Accuracy	0.20 % of reading
Bakeout temperature max. at the flange	$\leq 110\text{ }^{\circ}\text{C}$ $\leq 230\text{ }^{\circ}\text{F}$ $\leq 383\text{ K}$
Full Scale	1,000 hPa 750 Torr 1,000 mbar
Measurement range max.	1,100 hPa 825 Torr 1,100 mbar
Measurement range min.	$1 \cdot 10^{-1}\text{ hPa}$ $7.5 \cdot 10^{-2}\text{ Torr}$ $1 \cdot 10^{-1}\text{ mbar}$
Membrane and measuring chamber	Ceramics (Al_2O_3 99.5 %)
Method of measurement	Capacitance
Nominal diameter	DN 16 ISO-KF
Output signal: Minimum load	10 k Ω
Output signal: Pressure range	1 - 9.8 V
Output signal: Sensor error above	> 9.8 V
Output signal: Sensor error below	< 0.4 V
Pipe and flange	Stainless steel
Pressure max.	3,000 hPa 2,250 Torr 3,000 mbar
Protection category	IP30
Resolution	0.003 % F.S.
Response time	30 ms
Sensor cable length	$\leq 120\text{ m}$
Supply: Power consumption max.	$\leq 1\text{ W}$
Supply: Voltage	14–30 V DC
Temperature: Operating	5-50 $^{\circ}\text{C}$ 41-122 $^{\circ}\text{F}$ 278-323 K
Temperature: Storage	-40-65 $^{\circ}\text{C}$ -40-149 $^{\circ}\text{F}$ 233-338 K
Temperature effect: on span	0.01 % of reading/ $^{\circ}\text{C}$
Temperature effect: on zero	0.005 % F.S./ $^{\circ}\text{C}$
Volume	$\leq 3.6\text{ cm}^3$
Weight	$\leq 330\text{ g}$

Order number	
CMR 361	PT R24 601

Accessories	
Accessory for ActiveLine gauges and controllers	
Mating connector	B 4707 283 MA
Sensor cable, 3 m	PT 448 250 -T
Vacuum accessories	
Centering ring with metal mesh-fine filter, pore size 4 m, FPM/stainless steel	PT 120 132 -T
Centering ring with poral filter, pore size 20 m, FPM/stainless steel	PF 117 216 -T