



## A 100 L Standard version

Compact light duty dry pump with pumping  
speed of 100 m<sup>3</sup>/h





Similar Image

## A 100 L Standard version, Low voltage, RS232/485 interface, 19 pins I/O

- High throughput, pumping speed 100 m<sup>3</sup>/h
- Low voltage 200 V - 230 V AC power supply
- RS232/485 interface
- 19 pins interface connector with +15 V power supply

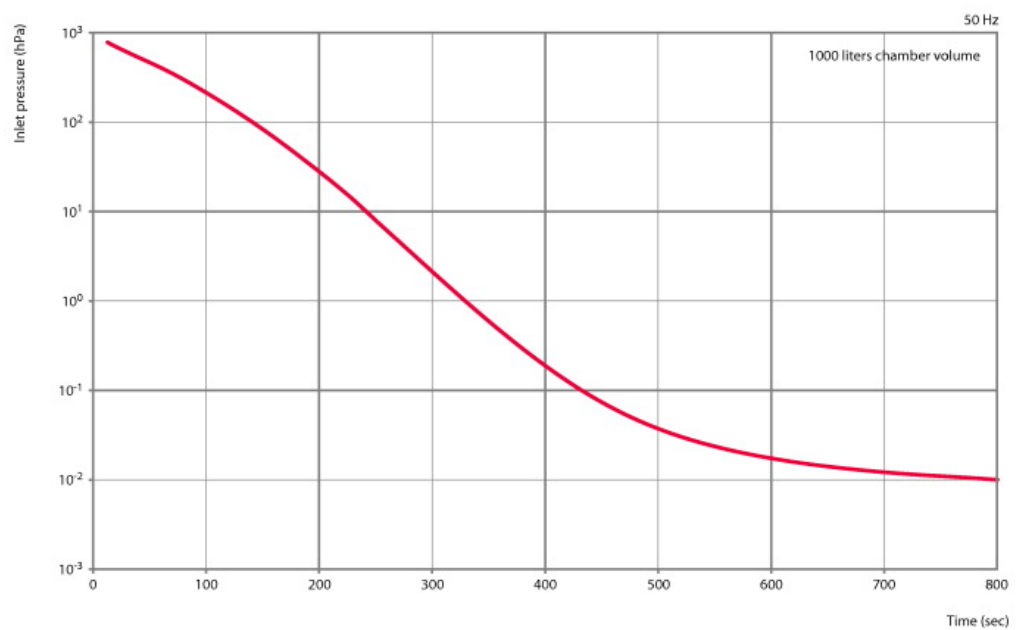
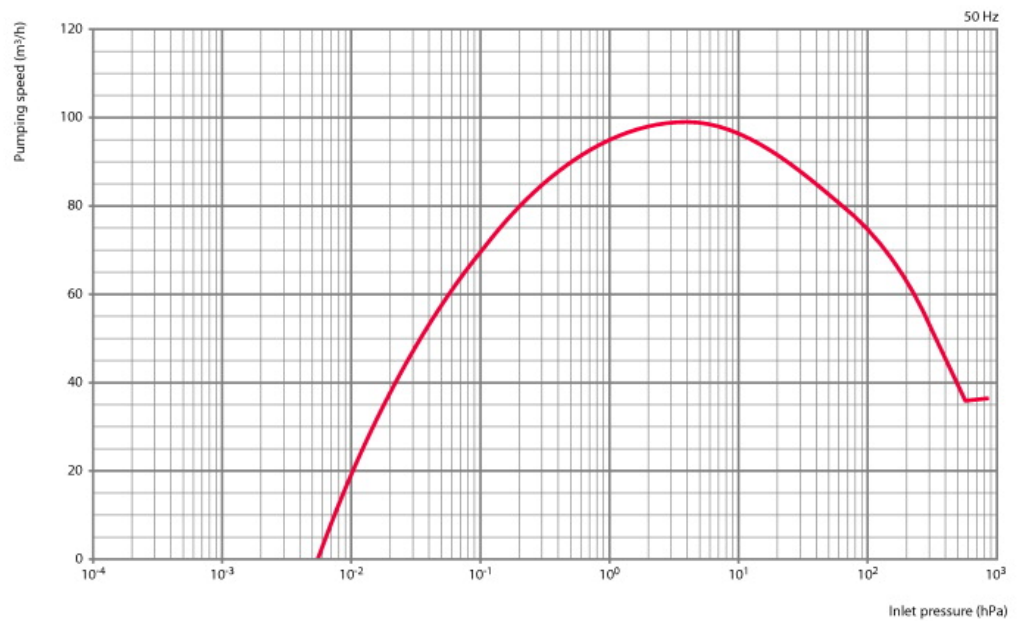

## Dimensions

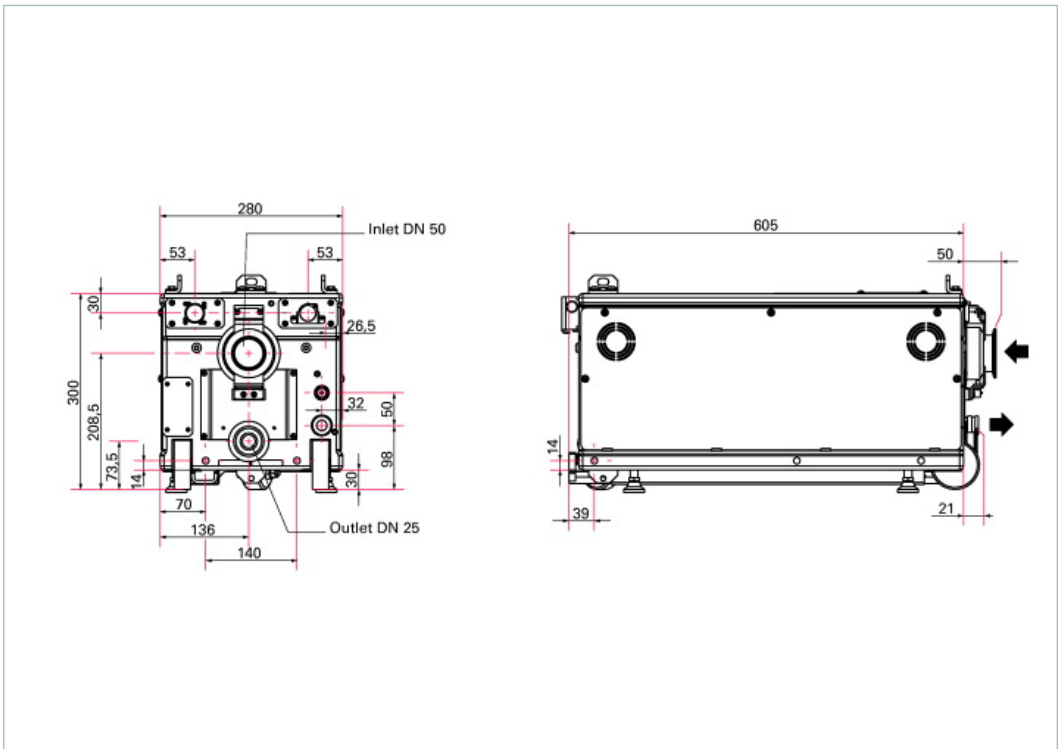

Technical Data	A 100 L Standard version, Low voltage, RS232/485 interface, 19 pins I/O
Continuous inlet flow, max.	20 Slm
Cooling	Water
Cooling water flow, min.	1.6 l/mn
Cycling period, max.	On 25 liters volume: 40 s
Flange (in)	DN 50 ISO-KF
Flange (out)	DN 25 ISO-KF
Frequency	50-60 Hz
I/O interfaces	SPI 19 pins
Interface	RS232/485
Noise level, max.	58 dB (A)
Power consumption at ultimate pressure	1.6 kW
Power consumption in standby mode	0.5-1.2 kW
Power supply voltage, 3 phases	200-230 V
Processes	Light Duty Applications
Pumping speed	100 m <sup>3</sup> /h
Typical ultimate pressure	6.6 · 10 <sup>-3</sup> hPa   4.95 · 10 <sup>-3</sup> Torr   6.6 · 10 <sup>-3</sup> mbar
Typical vibration acceleration (at inlet flange 10-1000 Hz)	0.1 m.s <sup>-2</sup>
Typical vibration displacement (at inlet flange 10-1000 Hz)	1.5 µm
Typical vibration speed (at inlet flange 10-1000 Hz)	1 mm.s <sup>-1</sup>
Version	Standard
Volume size, max.	1 m <sup>3</sup>
Weight	100 kg   220.46 lb

Order number	
A 100 L Standard version	A100L31434

Accessories	
<b>Accessories</b>	
Anti earthquakesquare kit	<b>109790</b>
Anti-noise device	<b>110868</b>
Emergency stop	<b>107849</b>
N <sub>2</sub> pressurization kit	<b>107956S</b>
Oil mist eliminator OME 25 C/H	<b>066849</b>