



Okta 2000

Roots pump with a pumping speed of 1,075 to 3,230 m³/h:





Similar Image

Okta 2000 M, Roots pump, 230/400 V, 50 Hz; 265/460 V, 60 Hz

- High-performance Roots pump with a pumping speed of 1075 to 3230 m³/h and magnetic coupling
- For mains voltage: 230/400 V, 50 Hz
- No thermal overload thanks to integral overflow valve
- For applications in the low and medium vacuum

Okta = Standard pumps with radial shaft sealing rings, housing parts made of gray cast iron or nodular graphite cast iron, flange connection in accordance with ISO-F

Okta M = Standard pumps, hermetically sealed thanks to magnetic coupling, housing parts made of gray cast iron nodular graphite cast iron, flange connection in accordance with ISO-F

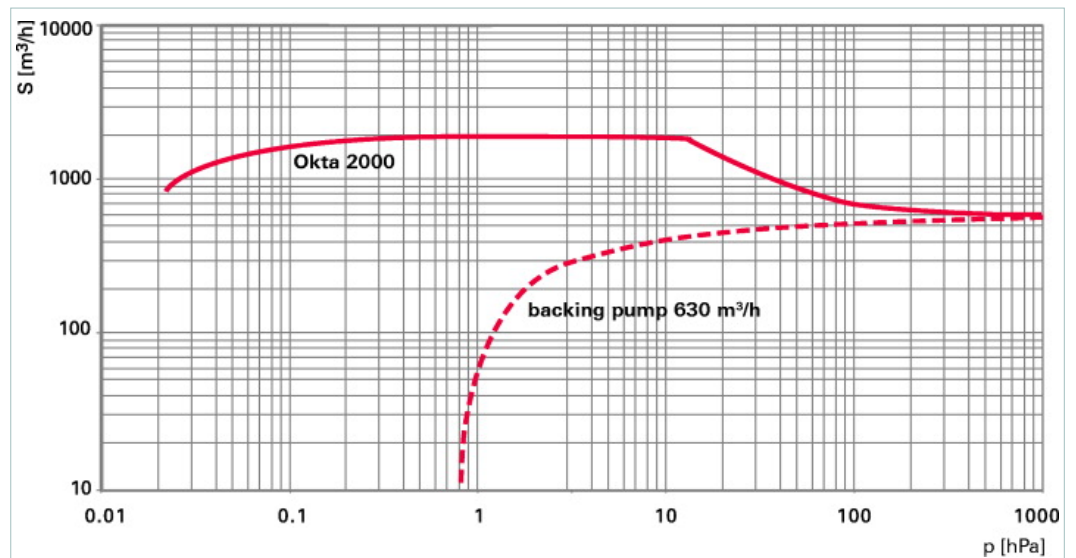

Dimensions

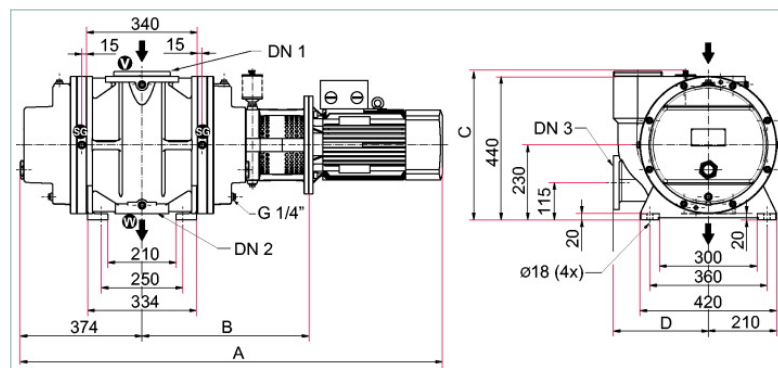

A	1317 mm
B	532 mm
C	458 mm
D	292 mm
DN 1	DN 160 ISO-F
DN 2	DN 100 ISO-F
DN 3	DN 100 ISO-F

Technical Data

Okta 2000 M, Roots pump, 230/400 V, 50 Hz; 265/460 V, 60 Hz

Ambient temperature	5-40 °C 41-104 °F 278-313 K
Cooling method, standard	Air
Differential pressure at the overflow valve	35 hPa 26.25 Torr 35 mbar
Emission sound pressure level (EN ISO 2151) at intake pressure 10 hPa	75 dB (A)

Technical Data		Okta 2000 M, Roots pump, 230/400 V, 50 Hz; 265/460 V, 60 Hz	
Emission sound pressure level (EN ISO 2151) at intake pressure 1 hPa		72 dB (A)	
Flange (in)		DN 160 ISO-F	
Flange (out)		DN 100 ISO-F	
Leak rate		1 · 10 ⁻⁶ Pa m ³ /s 7.5 · 10 ⁻⁶ Torr l/s 1 · 10 ⁻⁵ mbar l/s	
Mains requirement: voltage 50 Hz		230/400 V	
Mains requirement: voltage 60 Hz		265/460 V	
Motor protection		3TF	
Nominal pumping speed		1075-3230 m ³ /h	
Nominal pumping speed at 50 Hz		2155 m ³ /h	
Nominal pumping speed at 60 Hz		2585 m ³ /h	
Nominal rotation speed at 50 Hz		3000 min ⁻¹	
Nominal rotation speed at 60 Hz		3600 min ⁻¹	
Operating fluid		P3	
Operating fluid filling		5 l	
Protection category		IP 55	
Rated power 50 Hz		5.5 kW	
Rated power 60 Hz		6.3 kW	
Rotation speed		from 1500 to 4500 min ⁻¹	
Rotation speed max.		4500 min ⁻¹	
Rotation speed min.		1500 min ⁻¹	
Version		Standard with motor and magnetic coupling	
Weight: with motor		360 kg 793.66 lb	

Order number	
Okta 2000	PP W62 000

Accessories	
Accessories	
Oil level monitoring 20-250 V AC for Okta 250 / M / Okta 500 / M / Okta 1000 / M / Okta 2000 / M / Okta 4000 / M / Okta 6000 / M, G 1 1/4	PK 004 930 -U
Oil level monitoring 24 V DC for Okta 250 / M / Okta 500 / M / Okta 1000 / M / Okta 2000 / M / Okta 4000 / M / Okta 6000 / M, G 1 1/4	PK 005 639 -U
Adjusting elements for fastening the feet.	
Setting elements for foot mounting for Okta 2000 / M / Okta 4000 / M / Okta 6000 / M / Okta 1500 G, 29 mm	PP 144 118 -T
Blank flange sets	
Blank flange set (Stainless steel) for Okta 1000 / M / ATEX / Okta 2000 / M / ATEX, DN PN16/PN10	PP 043 885 -T
Blank flange set (Stainless steel) for Okta 1000 / M / Okta 2000 / M, DN ISO-K	PP 043 884 -T
Blank flange set for Okta 1000 / M / Okta 2000 / M, Stainless steel	PP 043 883 -T
DN ISO-F	
Mounting bolts (Stainless steel) for Okta 1000 / M / Okta 1000 / M, Okta 2000 / M, DN ISO-F	PP 043 878 -T
Mounting bolts (Zinc-plated Steel) for Okta 1000 / M / Okta 1000 / M, Okta 2000 / M, DN ISO-F	PP 043 873 -T
DN ISO-K	
Claw set (Stainless steel) for Okta 1000 / M / Okta 1000 / M, Okta 2000 / M, DN ISO-K	PP 043 879 -T
Claw set (Zinc-plated Steel) * for Okta 1000 / M / Okta 1000 / M, Okta 2000 / M, DN ISO-K	PP 043 881 -T
Claw set (Zinc-plated Steel) for Okta 1000 / M / Okta 1000 / M, Okta 2000 / M, DN ISO-K	PP 043 880 -T
DN PN16/PN10	
Mounting bolts (Zinc-plated Steel) for Okta 2000 / M / ATEX, DN PN16/PN10	PP 144 117 -T
Frequency converter	
Frequency converter (Complete with control box) Okta 2000 / M	PP 078 304 -T
Gear chamber evacuation	
Gear box exhaust (Flexible hose) for Okta 2000 / M, G 3/8 (3x)	PP 144 121 -T
Gear box exhaust (Plastic hose) for Okta 2000 / M, G 3/8 (3x)	PP 144 120 -T
Oil compensating line (with oil level monitoring)	
Oil compensating line with oil level monitoring for Okta 2000 / M, G 3/8 (4x), G 1 1/4 (1x)	PP 031 448 -T
Purge gas kit	
Sealing gas kit for Okta 250 / M / Okta 500 / M / Okta 1000 / M / Okta 2000 / M / Okta 4000 / M / Okta 6000 / M / Okta 8000 / Okta 1500 G / Okta 4000 G / Okta 8000 G, G 3/8 (4x)	PP 027 401 -T
Sealing kits	
Centering ring with outer ring for vacuum flange for Okta 1000 / M / Okta 2000 / M, DN ISO-F	PF 303 116 -T
Centering ring with outer ring for vacuum flange for Okta 500 / M / Okta 500 G, DN ISO-F	PF 303 110 -T
Seal kit (FKM) for Okta 1000 / M / ATEX, DN PN16/PN10	PP 043 886 -T
Splinter shield	
Splinter shield for Okta 1000/1000 M/1500 G/2000/2000 M	PP 031 114 -X
Splinter shield for Okta 1000/2000 AD-Series	PP 031 115 -X

Accessories	
Sprayer	
Sprayer DN ISO-F for Okta 1000 / M / Okta 2000 / M	PP 031 252 -T
Sprayer DN PN16/PN10 for Okta 1000 / M / Okta 2000 / M / Okta 1500 G	PP 031 243 -T
Temperature sensor	
Temperature sensor for Okta 250 / M / Okta 500 / M / Okta 1000 / M / Okta 2000 / M / Okta 4000 / M / Okta 6000 / M / Okta 500 G / Okta 1500 G / Okta 4000 G, G 3/8	PP 041 457 -T
Consumables	
P3, mineral oil, 1 l	PK 001 106 -T
P3, mineral oil, 5 l	PK 001 107 -T