



# HiPace<sup>®</sup> 300 M





Similar Image

## HiPace® 300 M with TM 700, DN 100 ISO-F

- 5-axis magnetically levitated turbopump with a pumping speed of 255 l/s for N<sub>2</sub>
- Integrated digital magnetic bearing controller TM 700
- Installation in any orientation; flexible through connectivity of up to 4 accessory parts
- With integrated water cooling for maximum gas throughput
- Interfaces: RS-485, Remote (Profibus/DeviceNet on request)
- The turbopump features extremely low vibration and is oil-free
- With patented In-field sensor calibration
- Including venting valve and patented "pulsed venting"
- Protection Class: IP 54
- Extensive accessories expand the range of applications

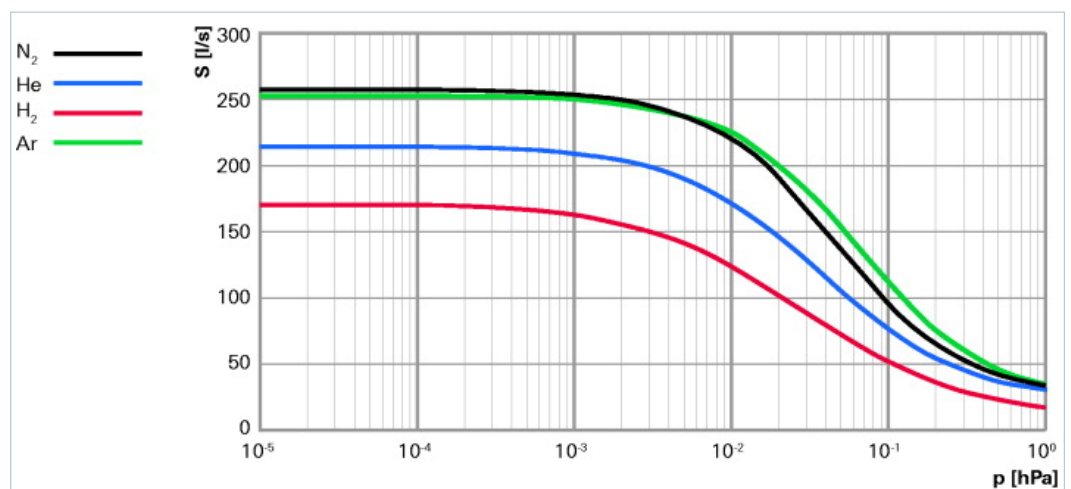

### Dimensions

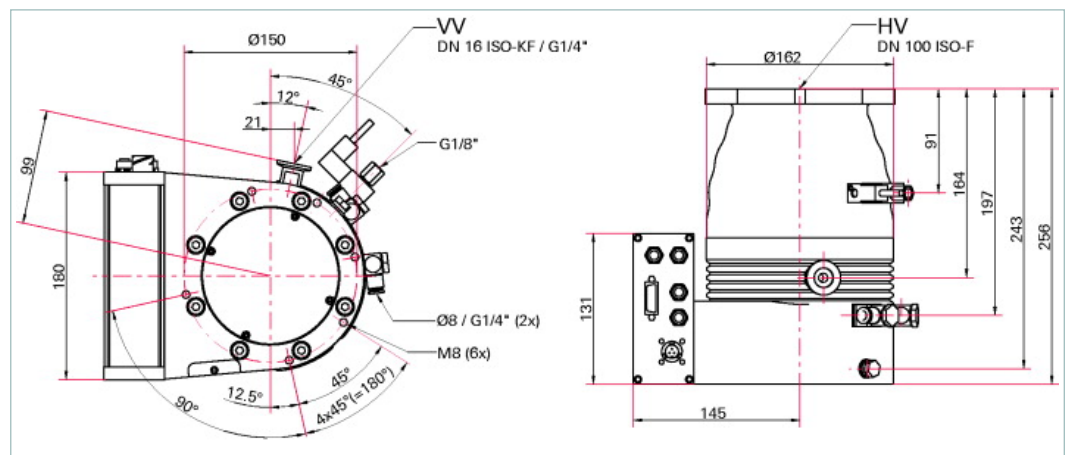

Technical Data	HiPace® 300 M with TM 700, DN 100 ISO-F
Bearing	Magnetically Levitated
Compression ratio for Ar	$> 1 \cdot 10^{11}$
Compression ratio for H <sub>2</sub>	$5 \cdot 10^5$
Compression ratio for He	$> 1 \cdot 10^8$
Compression ratio for N <sub>2</sub>	$> 1 \cdot 10^{11}$
Cooling method, optional	Air, convection
Cooling method, standard	Water
Cooling water consumption	80 l/h

Technical Data	HiPace® 300 M with TM 700, DN 100 ISO-F
Cooling water temperature	15-35 °C   59-95 °F   288-308 K
Electronic drive unit	with TM 700
Flange (in)	DN 100 ISO-F
Flange (out)	DN 16 ISO-KF
Fore-vacuum max. for N <sub>2</sub>	20 hPa   15 Torr   20 mbar
Gas throughput at 0.1 hPa HV for Ar	11 hPa l/s   8.25 Torr l/s   11 mbar l/s
Gas throughput at 0.1 hPa HV for H <sub>2</sub>	5 hPa l/s   3.75 Torr l/s   5 mbar l/s
Gas throughput at 0.1 hPa HV for He	8 hPa l/s   6 Torr l/s   8 mbar l/s
Gas throughput at 0.1 hPa HV for N <sub>2</sub>	10 hPa l/s   7.5 Torr l/s   10 mbar l/s
Gas throughput at full rotational speed for Ar	13 hPa l/s   9.75 Torr l/s   13 mbar l/s
Gas throughput at full rotational speed for N <sub>2</sub>	28 hPa l/s   21 Torr l/s   28 mbar l/s
Interfaces	RS-485, Remote
Low vibrations	yes
Mounting orientation	in any orientation
Operating voltage	48 (± 5 %) V DC
Permissible magnetic field max.	5 mT
Protection category	IP 54
Pumping speed for Ar	250 l/s
Pumping speed for H <sub>2</sub>	170 l/s
Pumping speed for He	215 l/s
Pumping speed for N <sub>2</sub>	255 l/s
Rotation speed ± 2 %	60000 min <sup>-1</sup>
Rotation speed variable	20-100 %
Run-up time	< 2 min
Sound pressure level	≤ 45 dB (A)
Ultimate pressure according to PNEUROP	< 1 · 10 <sup>-7</sup> hPa   < 7.5 · 10 <sup>-8</sup> Torr   < 1 · 10 <sup>-7</sup> mbar
Venting connection	G 1/8"
Weight	13.4 kg   29.54 lb

Order number
HiPace® 300 M
PM P03 951

Accessories	
<b>Accessory for TC 400/1200 and TM 700</b>	
Y-connector, shielded, M12 for accessories	P 4723 013
<b>Adapter and control cables</b>	
Control cable for pumping stations 0.7 m	PM 061 675 AT
HiPace - ACP connection cable	PM 071 142 -X
<b>Air cooling</b>	
Air cooling, shielded, for HiPace 400/700/800 and 300700/800 M with TC 400 PB/TM 700	PM Z01 363
<b>Connection cables</b>	
Connection cable for HiPace with TC 400/TM 700 to power supply TPS/DCU 310/311/400/401	PM 061 352 -T
<b>Control and display units</b>	
Accessories package for HPU 001/PC	PM 061 005 -T
DCU 002, Display Control Unit	PM 061 348 -T
HPU 001, Handheld Programming Unit	PM 051 510 -T
<b>DCU with integrated power supply</b>	
DCU 400, Display control unit incl. power supply	PM C01 823
<b>DN ISO-F, Mounting kit</b>	
Mounting kit for DN 100 ISO-F, including coated centering ring, hexagon screws	PM 016 450 -T
Mounting kit for DN 100 ISO-F, including coated centering ring, protection screen, stud screws	PM 016 457 -T
Mounting kit for DN 100 ISO-F, including coated centering ring, protective screen, hexagon screws	PM 016 452 -T
Mounting kit for DN 100 ISO-F, including coated centering ring, splinter shield, hexagon screws	PM 016 451 -T
Mounting kit for DN 100 ISO-F, including coated centering ring, splinter shield, stud screws	PM 016 456 -T
Mounting kit for DN 100 ISO-F, including coated centering ring, stud screws	PM 016 455 -T
<b>DN ISO-K / -F, sealings, splinter shields, protection screens</b>	
Centering ring with multifunction coating, DN 100 ISO-K/-F	PM 016 210 -U
Centering ring with multifunction coating and integrated protection screen, DN 100 ISO-K/-F	PM 016 212 -U
Centering ring with multifunction coating and integrated splinter shield, DN 100 ISO-K/-F	PM 016 211 -U
<b>Fore-vacuum safety valves</b>	
TVV 001 fore-vacuum safety valve, 115 V AC	PM Z01 206
TVV 001 fore-vacuum safety valve, 230 V AC	PM Z01 205
<b>Interface and extension cables</b>	
Interface cable, M12 m straight/M12 m straight, 3 m	PM 061 283 -T
<b>Mains cables</b>	
Mains cable 115 V AC, NEMA 5-15 to C13, 3 m	P 4564 309 ZE
Mains cable 208 V AC, NEMA 6-15 to C13, 3 m	P 4564 309 ZF
Mains cable 230 V AC, CEE 7/7 to C13, 3 m	P 4564 309 ZA
<b>Pressure Sensors</b>	
IKT 010, Digital Cold Cathode Sensor, low current	PTR 72 100
IKT 011, Digital Cold Cathode Sensor, high current	PT R73 100
RPT 010, Digital Piezo/Pirani Sensor	PT R71 100
TIC 010, Adapter for two sensors	PT R70 000

<b>Accessories</b>	
<b>Relay boxes</b>	
Relay box, shielded, for backing pumps, 1-phase 20 A for TC 400/1200, TM 700 and TCP 350, M12	<b>PM 071 285 -X</b>
Relay box, shielded, for backing pumps, 1-phase 7 A for TC 400/1200, TM 700 and TCP 350, M12	<b>PM 071 284 -X</b>
<b>RS-485</b>	
Connector M12 to RS-485	<b>PM 061 270 -X</b>
Termination resistor for RS-485	<b>PT 348 105 -T</b>
USB converter to RS-485 interface	<b>PM 061 207 -T</b>
Y-Connector M12 to RS-485	<b>P 4723 010</b>
<b>Sealing gas</b>	
Sealing gas throttle for HiPace 300	<b>PM Z01 317</b>
Sealing gas valve, shielded for HiPace 300 with TC 400 and TM 700, TCP 350	<b>PM Z01 312</b>
<b>TPS-19" rack module</b>	
Front panel kit for TPS 401	<b>PM 061 396 -T</b>
TPS 401, power supply 48 V DC, 19" partial plug-in 3HU	<b>PM 061 347 -T</b>
<b>TPS wall rail fitting</b>	
TPS 400, power supply 48 V DC, for wall/standard rail fitting	<b>PM 061 343 -T</b>
Wall rail fitting for TPS 110/180/310/400	<b>PM 061 392 -T</b>
<b>Venting accessory with small flange, G 1/8", hoses, air drier</b>	
TTV 001, dryer for venting turbopumps	<b>PM Z00 121</b>
<b>Venting valve (normally closed)</b>	
Venting valve, shielded, 24 V DC, G 1/8", for connection to TC 400/1200 and TM 700	<b>PM Z01 291</b>
<b>Vibration damper</b>	
Vibration damper for HiPace 300/400, DN 100 ISO-K/F	<b>PM 006 459 -X</b>

# 上海伯东--您理想的真空合作伙伴!

伯东公司成立于1953年,全球范围内有一千七百名员工。伯东企业(上海)有限公司([www.hakuto-vacuum.cn](http://www.hakuto-vacuum.cn))主要从事半导体设备、电子零部件加工、销售及相关服务工作,集团年营业额约为100亿人民币。伯东公司在国内主要城市:北京、苏州、广州、深圳、成都及厦门设有营业据点。

上海伯东真空产品事业部秉承为广大中国客户提供世界一流的真空产品、推动中国真空工艺发展、承担企业社会责任为经营理念,已累计为超过10,000家企业提供真空服务,覆盖工业、半导体、镀膜、科研和分析行业。

上海伯东代理品牌包含:德国Pfeiffer全系列真空产品、美国KRI离子源、美国Brooks Polycold制冷机,美国HVA真空阀门,美国inTEST(Temptronic)高速温度循环测试机,离子蚀刻机,真空镀膜系统及配套真空零配件等。

上海伯东作为国际知名真空品牌指定授权代理商,全权负责在中国地区的销售和维修服务,100%使用原厂进口零部件以及国外受训维修工程师;拥有完全的拆解,维修,校正能力并提供24小时在线服务。



Are you looking for a  
perfect vacuum solution?  
Please contact us:

伯东企业(上海)有限公司  
T +021 5046-3511  
[ec@hakuto-vacuum.cn](mailto:ec@hakuto-vacuum.cn)



[www.hakuto-vacuum.cn](http://www.hakuto-vacuum.cn)  
[www.hakuto-vacuum.com.tw](http://www.hakuto-vacuum.com.tw)

PFEIFFER  VACUUM

 伯東  
Hakuto

