



HiPace[®] 800

Maximum vacuum performance in a compact design with a pumping speed of 790 l/s for N₂





Similar Image

HiPace® 800 with TCP 350, DN 200 CF-F

- Compact yet powerful turbopump with a pumping speed of up to 790 l/s für N₂
- Maximum vacuum performance with minimum power consumption
- For installation in any orientation
- External TCP 350 drive electronics
- Integrated, powerful cooling system

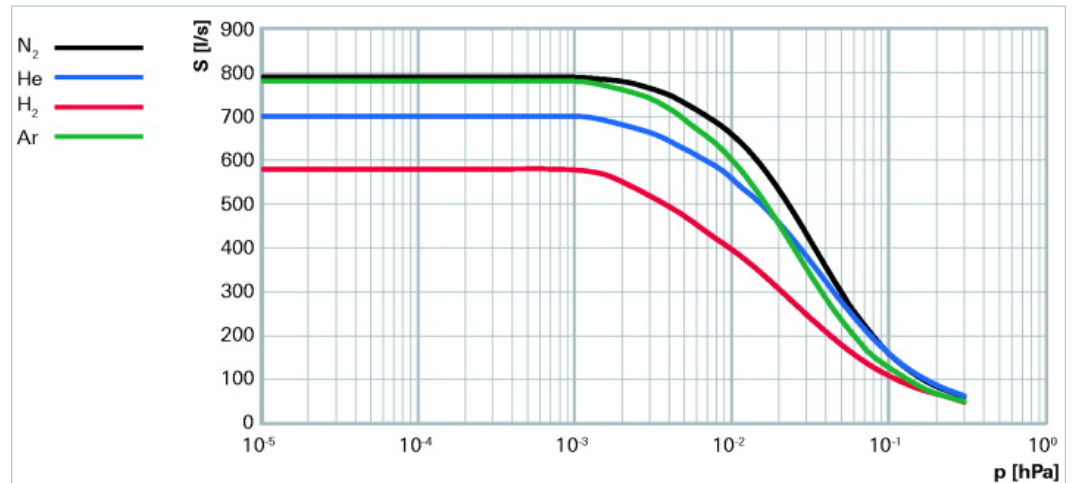

Dimensions

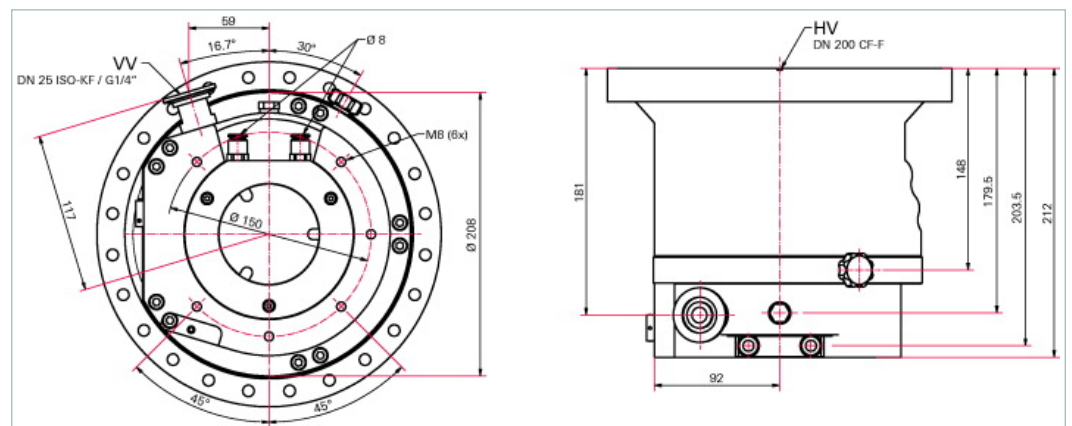

Technical Data	HiPace® 800 with TCP 350, DN 200 CF-F
Bearing	Hybrid
Compression ratio for Ar	$> 1 \cdot 10^{11}$
Compression ratio for H ₂	$4 \cdot 10^5$
Compression ratio for He	$3 \cdot 10^7$
Compression ratio for N ₂	$> 1 \cdot 10^{11}$
Cooling method, optional	Air
Cooling method, standard	Water
Cooling water consumption	100 l/h
Cooling water temperature	15-35 °C 59-95 °F 288-308 K
Electronic drive unit	TCP 350
Flange (in)	DN 200 CF-F / G 1/4"
Flange (out)	DN 25 KF
Fore-vacuum max. for Ar	11 hPa 8.25 Torr 11 mbar
Fore-vacuum max. for H ₂	6 hPa 4.5 Torr 6 mbar
Fore-vacuum max. for He	13 hPa 9.75 Torr 13 mbar
Fore-vacuum max. for N ₂	10 hPa 7.5 Torr 10 mbar

Technical Data	HiPace® 800 with TCP 350, DN 200 CF-F
Gas throughput at full rotational speed for Ar	1.5 hPa l/s 1.12 Torr l/s 1.5 mbar l/s
Gas throughput at full rotational speed for H ₂	> 8 hPa l/s > 6 Torr l/s > 8 mbar l/s
Gas throughput at full rotational speed for He	5 hPa l/s 3.75 Torr l/s 5 mbar l/s
Gas throughput at full rotational speed for N ₂	3 hPa l/s 2.25 Torr l/s 3 mbar l/s
Interface, extended	Profibus, DeviceNet, E74
Interfaces	RS-485, Remote
Mounting orientation	in any orientation
Permissible magnetic field max.	6 mT
Protection category	IP 54
Pumping speed for Ar	780 l/s
Pumping speed for H ₂	580 l/s
Pumping speed for He	700 l/s
Pumping speed for N ₂	790 l/s
Rotation speed ± 2 %	49200 min ⁻¹
Rotation speed variable	60-100 %
Run-up time	5.5 min
Separate electronic drive unit	yes
Sound pressure level	50 dB (A)
Venting connection	G 1/8"
Weight	18.2 kg 40.12 lb

Order number	
HiPace® 800	PM P04 671

Accessories	
Accessory external drive units	
Adapter cable, TCP 350 - backing pump relay box, M12	PM 061 377 -T
Air cooling	
Air cooling for HiPace 400/700 and 800 with TC 400	PM Z01 303
CF-F, Mounting kit	
Set of hexagon screws for through hole, DN 200 CF-F	PM 016 687 -T
Set of stud screws for through hole, DN 200 CF-F	PM 016 688 -T
CF-F, Sealings, splinter shields, protection screens	
Protection screen for DN 200 CF-F	PM 016 342
Splinter shield for turbopumps, DN 200 CF-F	PM 016 321
Connection cables	
Connection cable from TCP 350 to HiPace with 2 accessory ports M12, 3 m	PM 061 356 -T
Control and display units	
RJ 45 interface cable on M12 for HiPace	PM 051 726 -T
External drive units	
TCP 350 DN, drive electronics, DeviceNet	PM C01 742
TCP 350 electronic drive unit	PM C01 740
TCP 350 PB, drive electronics, Profibus	PM C01 741
Fore-vacuum safety valves	
TVV 001 fore-vacuum safety valve, 115 V AC	PM Z01 206
TVV 001 fore-vacuum safety valve, 230 V AC	PM Z01 205
Heating suitable for TC 110 and TC 400	
Heating jacket for HiPace 400/700/800 with TC 400, 115 V AC, UL plug	PM 061 371 -T
Heating jacket for HiPace 400/700/800 with TC 400, 208 V AC, UL plug	PM 061 370 -T
Heating jacket for HiPace 400/700/800 with TC 400, 230 V AC, safety plug	PM 061 369 -T
Mains cables	
Mains cable 115 V AC, NEMA 5-15 to C13, 3 m	P 4564 309 ZE
Mains cable 208 V AC, NEMA 6-15 to C13, 3 m	P 4564 309 ZF
Mains cable 230 V AC, CEE 7/7 to C13, 3 m	P 4564 309 ZA
Relay boxes	
Backing pump relay box, single phase 20 A, for TC 400 and TCP 350, M12 plug	PM 061 375 -T
Relay box, shielded, for backing pumps, 1-phase 7 A for TC 400/1200, TM 700 and TCP 350, M12	PM 071 284 -X
RS-485	
Connector M12 to RS-485	PM 061 270 -X
Power separator for RS-485	PT 348 132 -T
Termination resistor for RS-485	PT 348 105 -T
USB converter to RS-485 interface	PM 061 207 -T
Sealing gas	
Sealing gas throttle for HiPace 300 - 800	PM Z01 317
Sealing gas valve, shielded for HiPace 300/400/700 and 800 with TC 400 and TM 700	PM Z01 312
Venting accessory with small flange, G 1/8", hoses, air drier	
TTV 001, dryer for venting turbopumps	PM Z00 121
Venting valve (normally closed)	
Venting valve, shielded, 24 V DC, G 1/8", for connection to TC 400/1200 and TM 700	PM Z01 291
Vibration damper	
Vibration damper for HiPace 800/1200, DN 200 CF-F	PM 006 669 -X