



CMR 365, 0,1 hPa F.S., DN 16 ISO-KF



 **伯東**
Hakuto

PFEIFFER  **VACUUM**



Similar Image

CMR 365, 0,1 hPa F.S., DN 16 ISO-KF

- Precise pressure measurement independent of type of gas
- Measurement range up to four decades
- Gauge for connection to TPG
- Flange size: DN 16 ISO-KF
- Measurement range from $1 \cdot 10^{-5}$ hPa to 0.11 hPa
- Minimal zero drift
- Sensor in ceramic technology
- No memory effects
- Materials employed have identical temperature coefficients
- Precise temperature compensation
- Calibration test report included in delivery

Dimensions

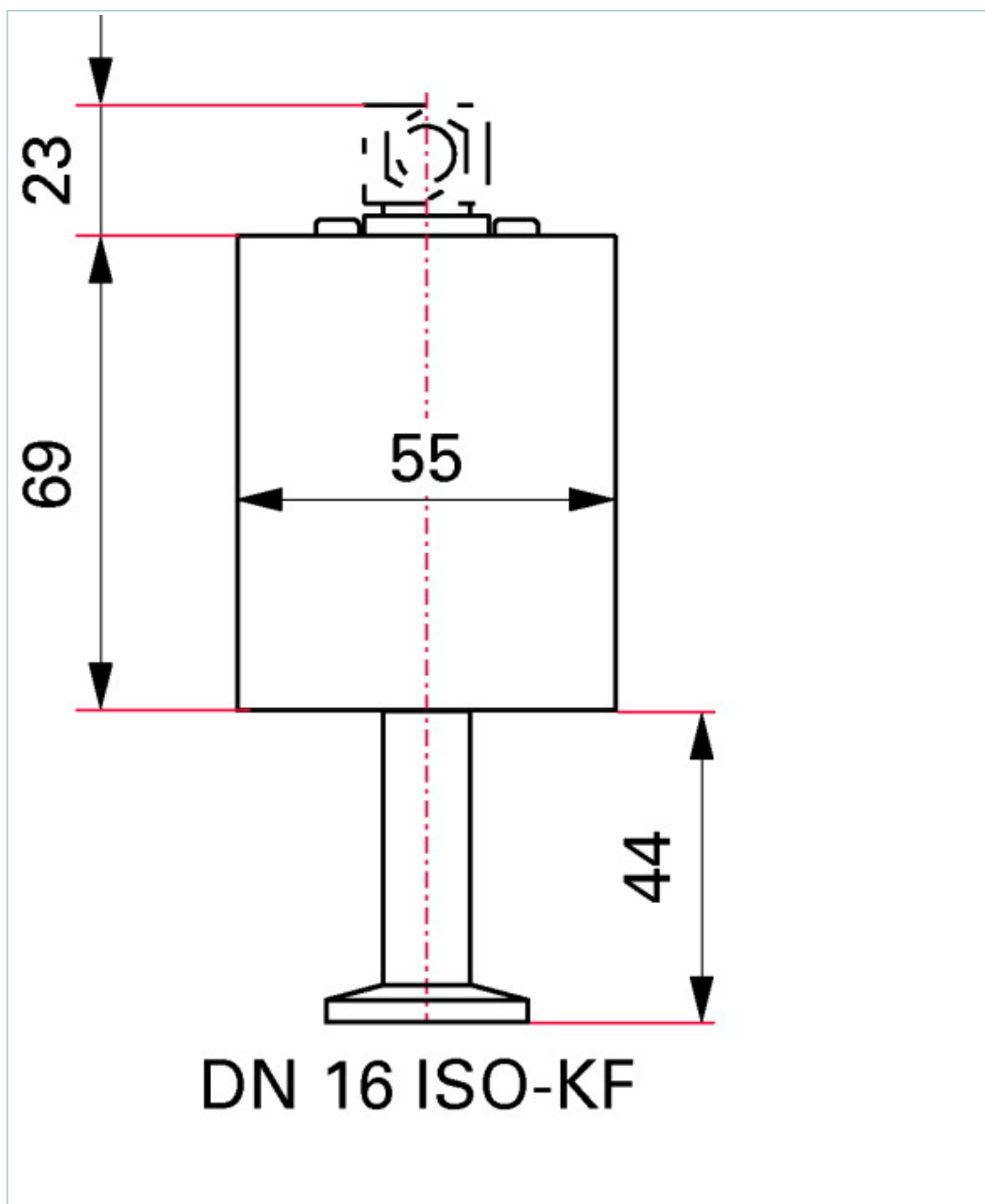

Technical Data	CMR 365, 0,1 hPa F.S., DN 16 ISO-KF
Accuracy	0.50 % of reading
Bakeout temperature max. at the flange	$\leq 110\text{ }^{\circ}\text{C}$ $\leq 230\text{ }^{\circ}\text{F}$ $\leq 383\text{ K}$
Full Scale	0.1 hPa 0.07 Torr 0.1 mbar
Measurement range max.	0.11 hPa 0.08 Torr 0.11 mbar
Measurement range min.	$1 \cdot 10^{-5}\text{ hPa}$ $7.5 \cdot 10^{-6}\text{ Torr}$ $1 \cdot 10^{-5}\text{ mbar}$
Membrane and measuring chamber	Ceramics (Al_2O_3 99.5 %)
Method of measurement	Capacitance
Nominal diameter	DN 16 ISO-KF
Output signal: Minimum load	10 k Ω
Output signal: Pressure range	1 - 9.8 V
Output signal: Sensor error above	> 9.8 V
Output signal: Sensor error below	< 0.4 V
Pipe and flange	Stainless steel
Pressure max.	1,300 hPa 975 Torr 1,300 mbar
Protection category	IP30
Resolution	0.003 % F.S.
Response time	130 ms
Sensor cable length	$\leq 120\text{ m}$
Supply: Power consumption max.	$\leq 1\text{ W}$
Supply: Voltage	14-30 V DC
Temperature: Operating	$5\text{-}50\text{ }^{\circ}\text{C}$ $41\text{-}122\text{ }^{\circ}\text{F}$ $278\text{-}323\text{ K}$
Temperature: Storage	$-40\text{-}65\text{ }^{\circ}\text{C}$ $-40\text{-}149\text{ }^{\circ}\text{F}$ $233\text{-}338\text{ K}$
Temperature effect: on span	0.03 % of reading/ $^{\circ}\text{C}$
Temperature effect: on zero	0.02 % F.S./ $^{\circ}\text{C}$
Volume	$\leq 3.6\text{ cm}^3$
Weight	$\leq 330\text{ g}$

Order number
CMR 365 PT R24 641

Accessories	
Accessory for ActiveLine gauges and controllers	
Mating connector	B 4707 283 MA
Sensor cable, 3 m	PT 448 250 -T
Vacuum accessories	
Centering ring with metal mesh-fine filter, pore size 4 m, FPM/stainless steel	PT 120 132 -T
Centering ring with poral filter, pore size 20 m, FPM/stainless steel	PF 117 216 -T